

ANNE ARUNDEL COUNTY DEPARTMENT OF PUBLIC WORKS

HARNES CREEK GULLY REPAIR

30% SCHEMATIC DESIGN

C. I. P. PROJECT NO. P584600 CONTRACT NO. P584605

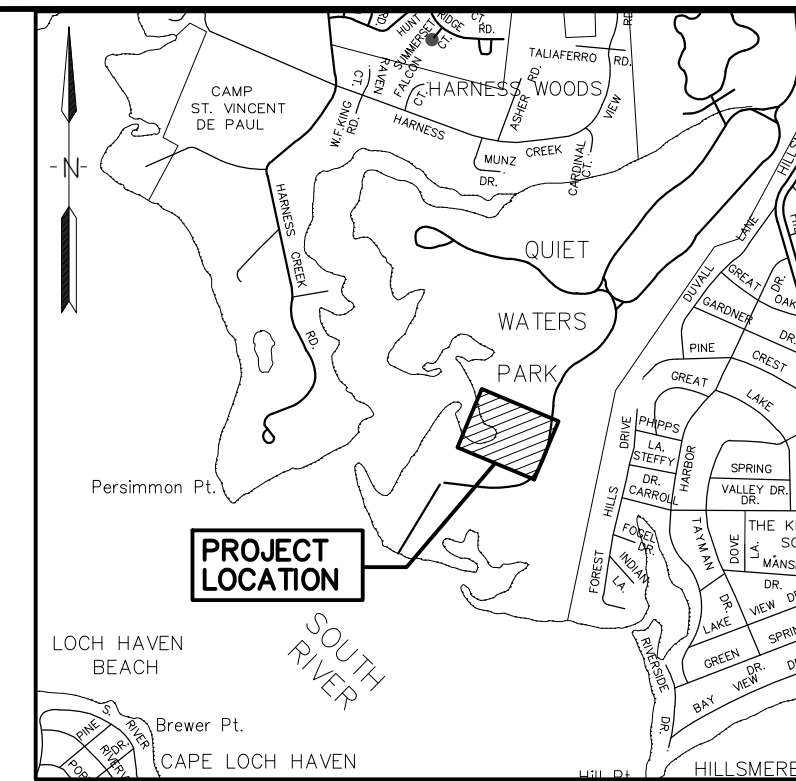

VICINITY MAP
SCALE: 1"=2,000'

INDEX OF SHEETS

NO.	SHEET	TITLE
1	TI-01	TITLE SHEET
2	EF-01	EXISTING FEATURES & DEMOLITION PLAN
3	GR-01	GRADING PLAN
4	DE-01	RSC DETAILS
5	DE-02	RSC DETAILS
6	DE-03	RSC DETAILS

STANDARD RESPONSIBILITY NOTES

I (WE) CERTIFY THAT:

- ALL DEVELOPMENT AND CONSTRUCTION WILL BE DONE IN ACCORDANCE WITH THIS SEDIMENT AND EROSION CONTROL PLAN, AND FURTHER, AUTHORIZE THE RIGHT OF ENTRY FOR PERIODIC ON-SITE EVALUATION BY THE ANNE ARUNDEL SOIL CONSERVATION DISTRICT (AASCD) BOARD OF SUPERVISORS OR THEIR AUTHORIZED AGENTS.
- ANY RESPONSIBLE PERSONNEL INVOLVED IN THE CONSTRUCTION PROJECT WILL HAVE A CERTIFICATE OF ATTENDANCE FROM THE MARYLAND DEPARTMENT OF THE ENVIRONMENT'S APPROVED TRAINING PROGRAM FOR THE CONTROL OF SEDIMENT AND EROSION BEFORE BEGINNING THE PROJECT.
RESPONSIBLE PERSONNEL ON SITE: TO BE DETERMINED AT PERMIT ISSUANCE.
- IF APPLICABLE, THE APPROPRIATE ENCLOSURE WILL BE CONSTRUCTED AND MAINTAINED ON SEDIMENT BASIN(S) INCLUDED IN THIS PLAN. SUCH STRUCTURE(S) WILL BE IN COMPLIANCE WITH THE ANNE ARUNDEL COUNTY CODE.
- THE DEVELOPER IS RESPONSIBLE FOR THE ACQUISITION OF ALL EASEMENTS, RIGHT, AND/OR RIGHTS-OF-WAY THAT MAY BE REQUIRED FOR THE SEDIMENT AND EROSION CONTROL PRACTICES, STORMWATER MANAGEMENT PRACTICES AND THE DISCHARGE OF STORMWATER ONTO OR ACROSS ADJACENT OR DOWNSTREAM PROPERTIES INCLUDED IN THE PLAN.
- FOR INITIAL SOIL DISTURBANCE OR RE-DISTURBANCE, PERMANENT AND/OR TEMPORARY STABILIZATION PER THE AASCD VEGETATIVE ESTABLISHMENT SHALL BE COMPLETED WITHIN THREE CALENDAR DAYS FOR THE SURFACE OF ALL CONTROLS, DIKES, SWALES, DITCHES, PERIMETER SLOPES AND ALL SLOPES GREATER THAN 3 HORIZONTAL TO 1 VERTICAL (3:1); AND SEVEN DAYS FOR ALL OTHER DISTURBED OR GRADED AREAS ON THE PROJECT SITE.
- THE GRADING AND SEDIMENT CONTROL APPROVAL ON THIS PLAN EXTENDS ONLY TO THOSE AREAS WITHIN THE LIMITS OF DISTURBANCE.
- THE APPROVAL OF THIS PLAN FOR SEDIMENT AND EROSION CONTROL DOES NOT RELIEVE THE DEVELOPER/CONSULTANT FROM COMPLYING WITH FEDERAL, STATE OR COUNTY REQUIREMENTS PERTAINING TO ENVIRONMENTAL ISSUES.
- THE DEVELOPER MUST REQUEST THAT THE SEDIMENT AND EROSION CONTROL INSPECTOR APPROVE WORK COMPLETED IN ACCORDANCE WITH THE APPROVED EROSION AND SEDIMENT CONTROL PLAN, THE GRADING OR BUILDING PERMIT, AND THE ORDINANCE.
- ALL MATERIAL SHALL BE TAKEN TO A SITE WITH AN APPROVED SEDIMENT AND EROSION CONTROL PLAN.
- FIRST PHASE INSPECTION AND APPROVAL OF THE SEDIMENT AND EROSION CONTROL INSPECTOR SHALL BE REQUIRED UPON COMPLETION OF THE INSTALLATION OF EROSION AND SEDIMENT CONTROLS PRIOR TO PROCEEDING WITH ANY OTHER EARTH DISTURBANCE OR GRADING. OTHER BUILDING OR GRADING INSPECTION APPROVALS MAY NOT BE AUTHORIZED UNTIL THE INITIAL APPROVAL BY THE SEDIMENT AND EROSION CONTROL INSPECTOR IS GIVEN. INSPECTION AND PERMITS MAY ALSO REQUIRE THAN AN INSPECTION AND CERTIFICATION OF THE INSTALLATION OF SEDIMENT CONTROL IS ALSO PERFORMED BY A DESIGN PROFESSIONAL PRIOR TO THE CONSTRUCTION COMMENCING.
- APPROVAL FROM THE INSPECTOR MUST BE REQUESTED ON FINAL STABILIZATION OF ALL SITES PRIOR TO REMOVAL OF SEDIMENT AND EROSION CONTROLS.
- EXISTING TOPOGRAPHY MUST BE FIELD VERIFIED BY RESPONSIBLE PERSONNEL TO THE SATISFACTION OF THE SEDIMENT CONTROL INSPECTOR PRIOR TO COMMENCING WORK.

SITE INFORMATION	
OWNER INFORMATION	ANNE ARUNDEL COUNTY C/O OFFICE OF REAL EST MGT 2662 RIVA RD FL 4 ANNAPOLIS, MD 21401
DEVELOPER INFORMATION	ANNE ARUNDEL COUNTY DEPT. OF PUBLIC WORKS 2662 RIVA RD. ANNAPOLIS, MD 21401 410-222-4126 ATTN: MELISSA HARLINSKI
ENGINEER	KCI TECHNOLOGIES, INC.
ENGINEER INFORMATION	936 RIDGEBROOK RD. SPARKS, MD 21152 410-316-7800
TAX MAP	56
PARCEL	88
DEED REF.	04224/00711
DISTRICT	2
ZONING	OS
PROPERTY AREA	336 AC
STREAM USE DESIGNATION	I
SUBWATERSHED	XX
WATERSHED	SOUTH RIVER

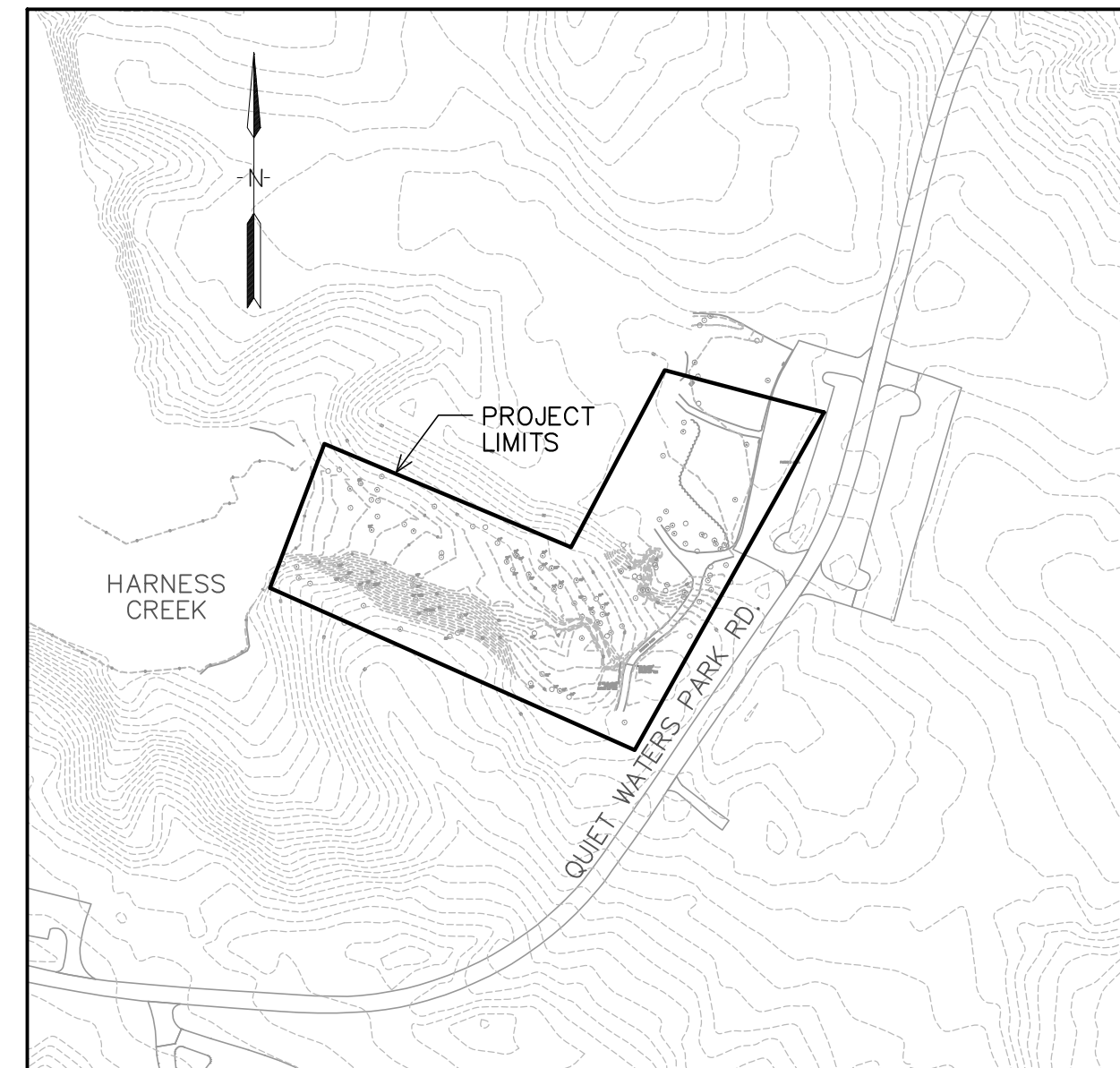

LOCATION MAP
SCALE: 1" = 200'

SITE ANALYSIS	
TOTAL SITE AREA	0.74 ac
PROPOSED DISTURBED AREA	0.74 ac
TOTAL AREA TO BE STABILIZED	0.74 ac
EXISTING IMPERVIOUS AREA	0.00 ac
ESTIMATED CUT	479 cu. yd
ESTIMATED FILL	339 cu. yd

*BORROW MATERIAL SHALL BE TAKEN OFF SITE TO A SITE WITH AN APPROVED SEDIMENT AND EROSION CONTROL PLAN.

CONTROL NOTE

HORIZONTAL AND VERTICAL CONTROL ESTABLISHED FROM REAL TIME KINEMATIC (RTK) GLOBAL POSITIONING SYSTEM (GPS) CONTROL POINTS. TRAVERSE POINTS ARE YELLOW PLASTIC CAP UNLESS OTHERWISE SPECIFIED. COORDINATES AND BEARINGS SHOWN HEREON ARE REFERRED TO THE MARYLAND COORDINATE SYSTEM (NAD83/1991). ELEVATIONS SHOWN HEREON ARE REFERRED TO THE NORTH AMERICAN VERTICAL DATUM OF 1988 (NAVD'88).

	NORTHING	EASTING	ELEVATION
TPS#1	462,083.84	1,453,602.58	26.67'
TPS#2	461,856.29	1,453,530.91	28.95'
TPS#3	461,847.94	1,453,344.74	27.39'
TPS#4	461,781.70	1,453,241.66	12.51'
TPS#5	461,824.43	1,453,084.24	7.18'
TPS#6	461,875.91	1,452,962.58	3.08'
TPS#7	462,009.30	1,452,836.79	3.78'

AS-BUILT CERTIFICATION

ALL GRADING, DRAINAGE, STRUCTURES, AND EROSION AND SEDIMENT CONTROL PRACTICES INCLUDING FACILITIES AND VEGETATIVE MEASURES HAVE BEEN COMPLETED IN CONFORMANCE WITH THE APPROVED PLANS AND SPECIFICATIONS AS REQUIRED BY COMAR 26.17.01.07B(3)(h).

DEVIATIONS AND DIFFERENCES IN CONSTRUCTED FIELD CONDITIONS ARE SHOWN (REDLINED) ON THESE AS-BUILT PRINTS.

STORMWATER MANAGEMENT SYSTEMS INDICATED ON THESE DRAWINGS HAVE BEEN INSTALLED IN SUBSTANTIAL CONFORMANCE WITH THE APPROVED PLANS AND SPECIFICATIONS.

PROFESSIONAL ENGINEER/OWNER/PERMITTEE DATE

DRAFTING STANDARDS AS PER ANNE ARUNDEL COUNTY DESIGN MANUAL CHAPTER 1, SECTION II

AASCD Block G.P.#

SIGNATURE OF THE OWNER/DEVELOPER DATE

PRINT: NAME: _____
TITLE: _____
AFFILIATION: _____
ADDRESS: _____
TELEPHONE NUMBER: _____
EMAIL ADDRESS: _____

CONSULTANT'S CERTIFICATION

THE DEVELOPER'S PLAN TO CONTROL SILT AND EROSION IS ADEQUATE TO CONTAIN THE SILT AND EROSION ON THE PROPERTY COVERED BY THE PLAN. I CERTIFY THAT THIS PLAN OF EROSION AND SEDIMENT CONTROL REPRESENTS A PRACTICAL AND WORKABLE PLAN BASED ON MY PERSONAL KNOWLEDGE OF THIS SITE, AND WAS PREPARED IN ACCORDANCE WITH THE REQUIREMENTS OF THE AASCD PLAN SUBMITTAL GUIDELINES AND THE CURRENT MARYLAND STANDARDS AND SPECIFICATIONS FOR SOIL EROSION AND SEDIMENT CONTROL. I HAVE REVIEWED THIS EROSION AND SEDIMENT CONTROL PLAN WITH THE OWNER/DEVELOPER.

SEAL

SIGNATURE _____

PE LICENSE NUMBER 31201 DATE _____

PRINT NAME JAMES A. TOMLINSON, P.E.

FIRM NAME KCI TECHNOLOGIES, INC.

FIRM ADDRESS 936 RIDGEBROOK ROAD

OUTFALL NOTES

A FIELD INVESTIGATION OF THE GULLY OUTFALL AND DOWNSTREAM TIDAL AREA WAS CONDUCTED IN MARCH 2022. THE PROPOSED SPSC WILL OUTFALL INTO TIDAL HARNES CREEK, WITH A FLAT, TIDAL WETLAND SLOPE TO OPEN WATER. THE OUTFALL IS WITHIN THE TIDAL ZONE; THEREFORE, FLOODING AND EROSION ARE NOT A CONCERN.

"PROFESSIONAL CERTIFICATION. I HEREBY CERTIFY THAT THESE DOCUMENTS WERE PREPARED OR APPROVED BY ME, AND THAT I AM A DULY LICENSED PROFESSIONAL ENGINEER UNDER THE LAWS OF THE STATE OF MARYLAND, LICENSE NO. 31201, EXPIRATION DATE: 2/1/2023."

SIGNATURE _____ DATE _____

OPERATION AND MAINTENANCE SCHEDULE

ROUTINE MAINTENANCE:

- FACILITY SHALL BE INSPECTED ONCE EVERY THREE YEARS. INSPECTIONS SHALL BE PERFORMED DURING OR SHORTLY AFTER WET WEATHER TO DETERMINE IF THE SPSC IS FUNCTIONING PROPERLY.
- SIDE SLOPES AND MAINTENANCE ACCESS SHALL BE SEEDED AS NEEDED.
- DEBRIS AND LITTER SHALL BE REMOVED DURING REGULAR MAINTENANCE OPERATIONS AND AS NEEDED.
- VISIBLE SIGNS OF EROSION IN SHALL BE REPAIRED AS SOON AS IT IS NOTICED.

NON-ROUTINE MAINTENANCE:

- STRUCTURAL COMPONENTS OF THE FACILITY SUCH AS THE WEIRS, SHALL BE REPAIRED UPON DETECTION OF ANY DAMAGE.

30% SCHEMATIC DESIGN TI-01

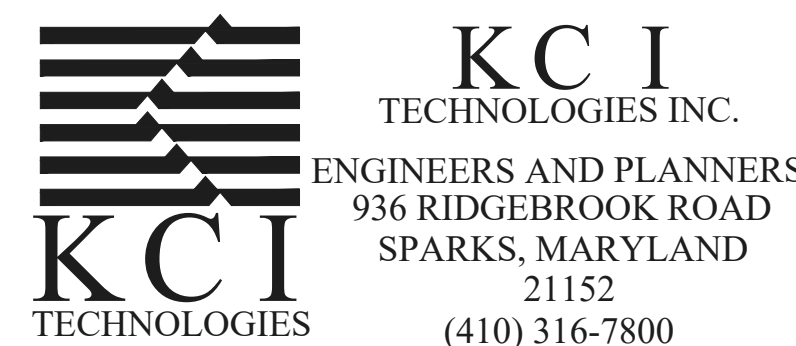

"PROFESSIONAL CERTIFICATION. I HEREBY CERTIFY THAT THESE DOCUMENTS WERE PREPARED OR APPROVED BY ME, AND THAT I AM A DULY LICENSED PROFESSIONAL ENGINEER UNDER THE LAWS OF THE STATE OF MARYLAND, LICENSE NO. 31201, EXPIRATION DATE: 2/1/2023."

SIGNATURE _____ DATE _____

ANNE ARUNDEL COUNTY DEPARTMENT OF PUBLIC WORKS					
REVISIONS	APPROVED	DATE	APPROVED	DATE	SCALE: AS SHOWN
NO. DATE BY					DRAWN BY: KL
	CHIEF ENGINEER		PROJECT MANAGER		CHECKED BY: JT
	APPROVED	DATE	APPROVED	DATE	SHEET NO. 1 OF 6
	WPRP ADMINISTRATOR		CHIEF RIGHT-OF-WAY		PROJECT NO.: P584600
					CONTRACT NO.: P584605
TITLE SHEET					
HARNES CREEK GULLY REPAIR APRIL 2022					
2ND ELECTION DISTRICT, TAX MAP 56, PARCEL 88, GRID 17, ZONING OS, ZIP CODE 21403					

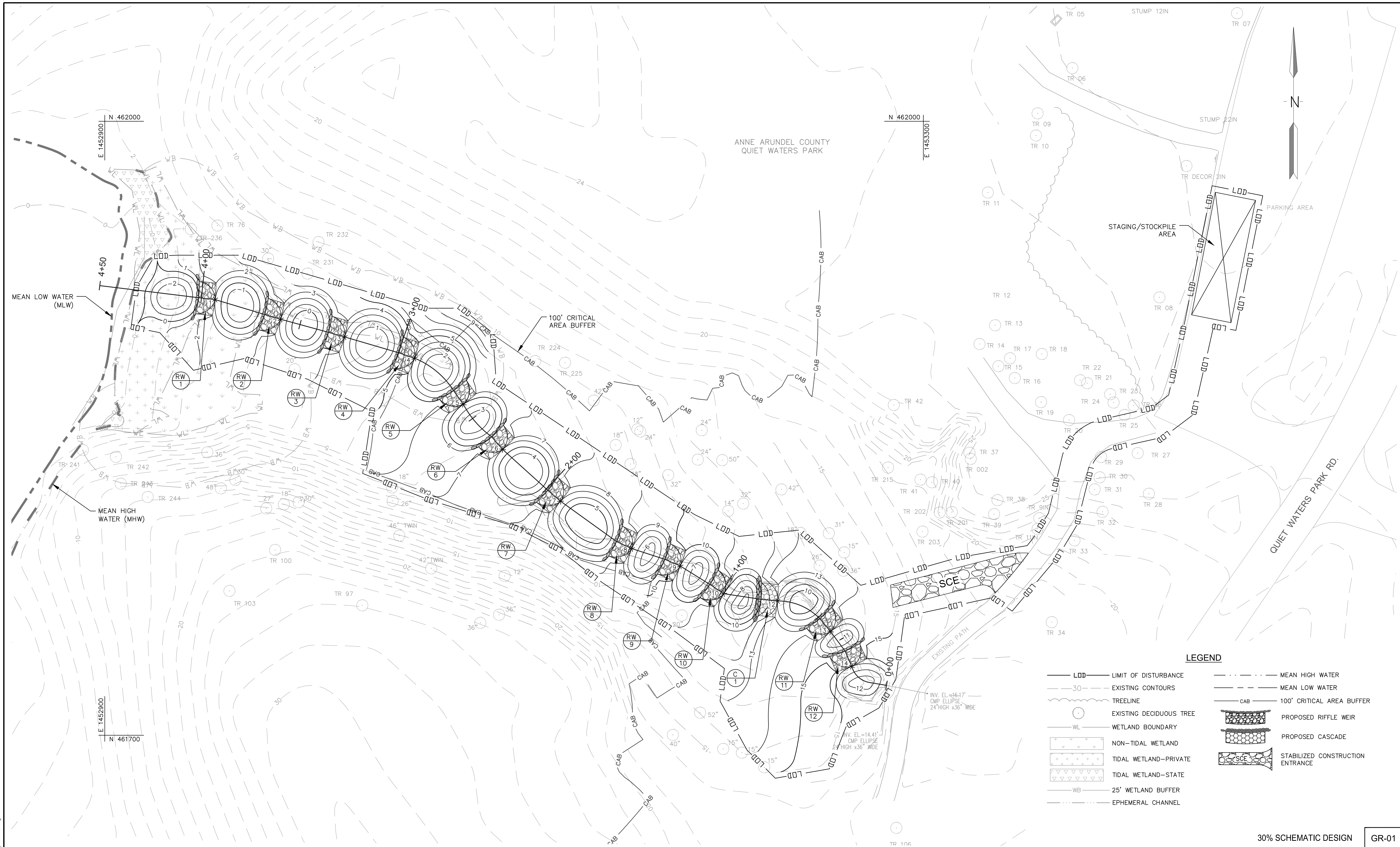

LEGEND

— LOD —	LIMIT OF DISTURBANCE	— MHW —	MEAN HIGH WATER
- - - 30 - - -	EXISTING CONTOURS	— MLW —	MEAN LOW WATER
~ ~ ~	TREELINE	— CAB —	100' CRITICAL AREA BUFFER
○	EXISTING DECIDUOUS TREE		PROPOSED RIFFLE WEIR
— WL —	WETLAND BOUNDARY		PROPOSED CASCADE
	NON-TIDAL WETLAND		STABILIZED CONSTRUCTION ENTRANCE
	TIDAL WETLAND-PRIVATE		
	TIDAL WETLAND-STATE		
— WB —	25' WETLAND BUFFER		
— Ephemeral Channel —	EPHEMERAL CHANNEL		

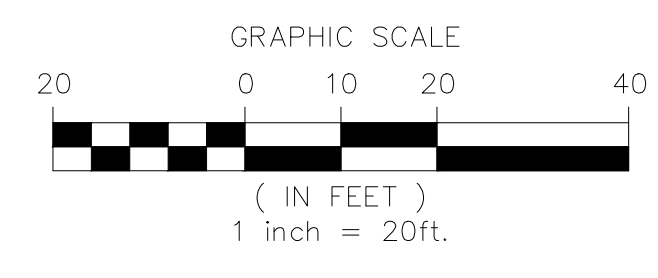

KCI
TECHNOLOGIES INC.
 ENGINEERS AND PLANNERS
 936 RIDGEBROOK ROAD
 SPARKS, MARYLAND
 21152
 (410) 316-7800

"PROFESSIONAL CERTIFICATION. I HEREBY CERTIFY THAT THESE DOCUMENTS WERE PREPARED OR APPROVED BY ME, AND THAT I AM A DULY LICENSED PROFESSIONAL ENGINEER UNDER THE LAWS OF THE STATE OF MARYLAND, LICENSE NO. 31201, EXPIRATION DATE: 2/1/2023."

SIGNATURE _____ DATE _____

ANNE ARUNDEL COUNTY
DEPARTMENT OF PUBLIC WORKS

REVISIONS		APPROVED	DATE	APPROVED	DATE	SCALE: 1"= 20'
NO.	DATE	BY				DRAWN BY: KL
				CHIEF ENGINEER		CHECKED BY: JT
				APPROVED	DATE	SHEET NO. 3 OF 6
				WPRP ADMINISTRATOR		PROJECT NO.: P584600
						CONTRACT NO.: P584605
				CHIEF RIGHT-OF-WAY		

GRADING PLAN
HARNESS CREEK GULLY REPAIR
 APRIL 2022
 2ND ELECTION DISTRICT, TAX MAP 56, PARCEL 88,
 GRID 17, ZONING OS, ZIP CODE 21403

30% SCHEMATIC DESIGN **GR-01**

Apr 11, 2022 - 4:41pm User: kathy.larkin
 M:\2018\10\06\07_15\Drawings\03_Grading\Plan_HarnessC.dwg

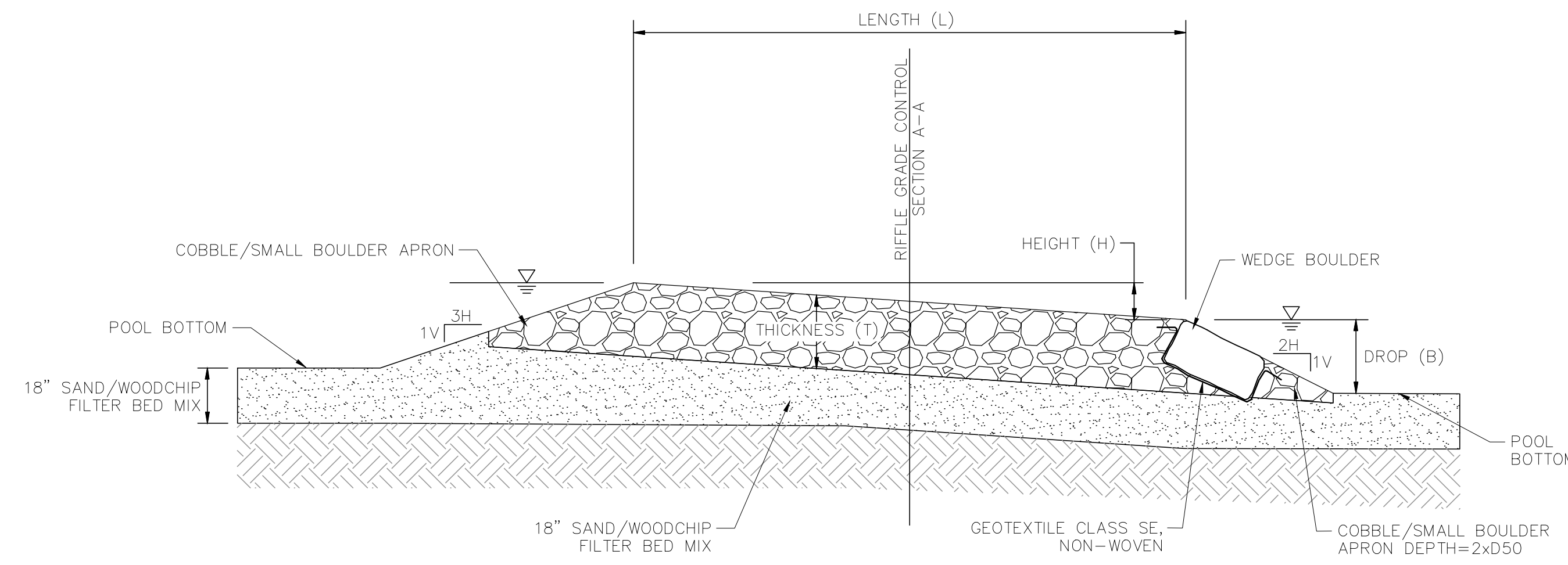

RIFFLE GRADE CONTROL PROFILE TYPICAL
NOT TO SCALE

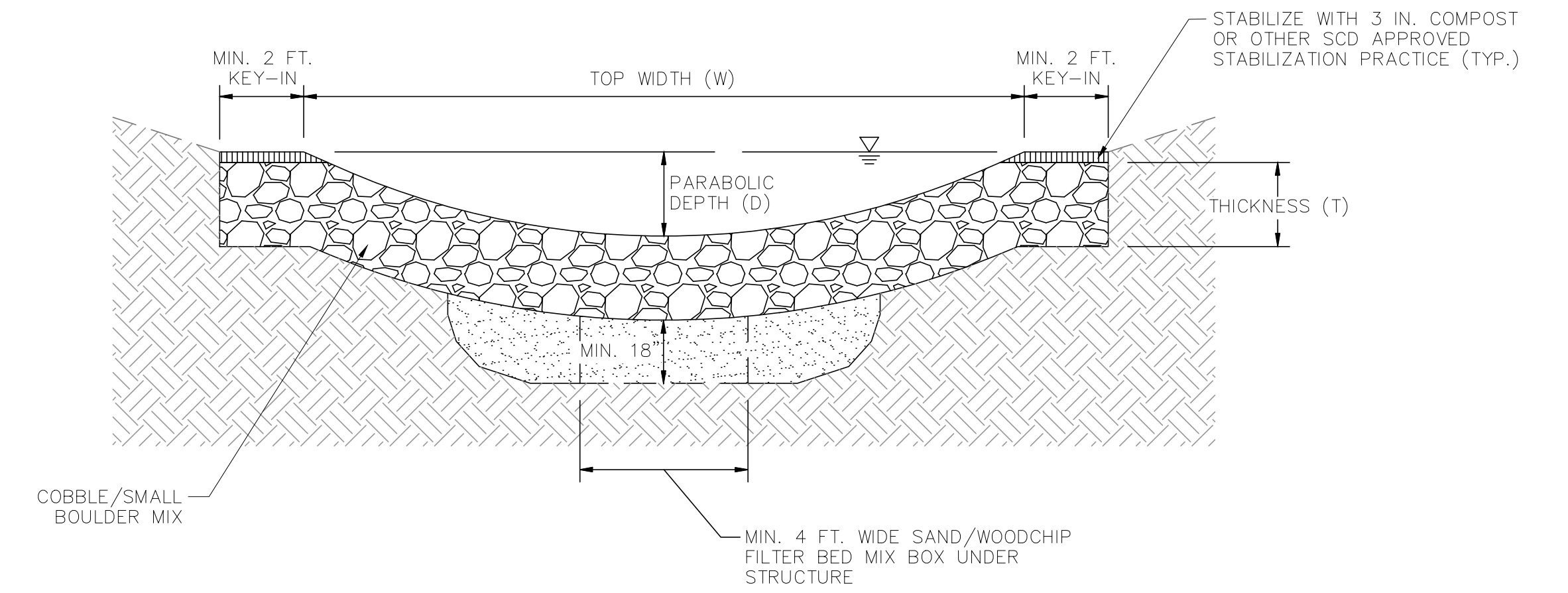

RIFFLE GRADE CONTROL TYPICAL SECTION A-A
NOT TO SCALE

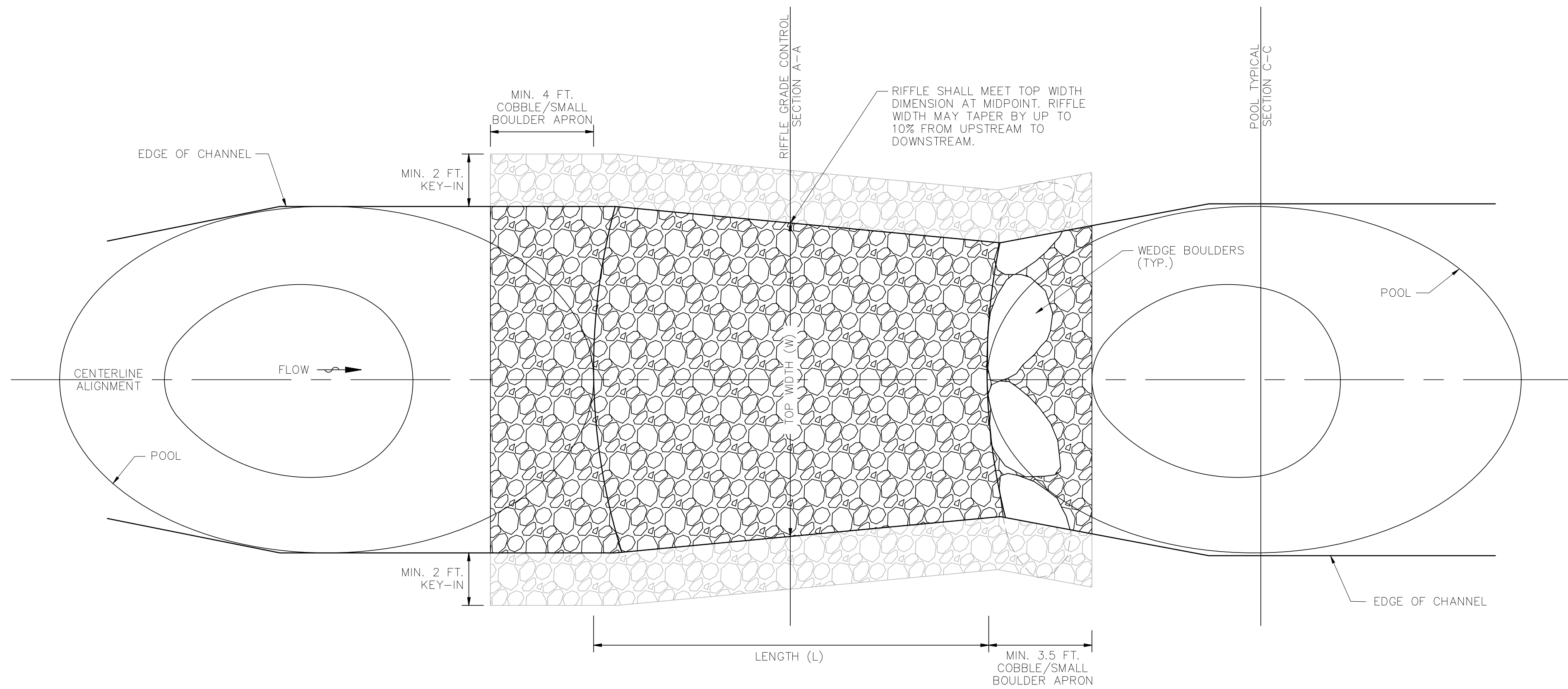

RIFFLE GRADE CONTROL PLAN TYPICAL
NOT TO SCALE

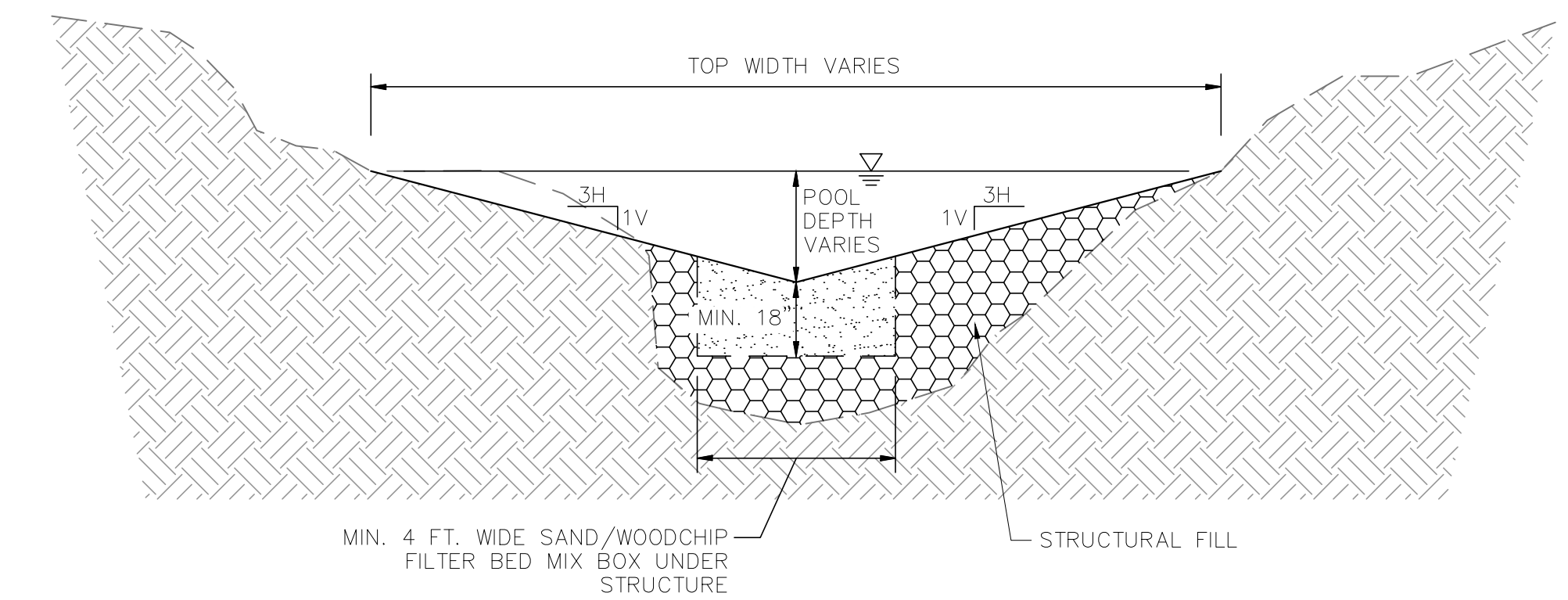

POOL TYPICAL SECTION C-C
NOT TO SCALE

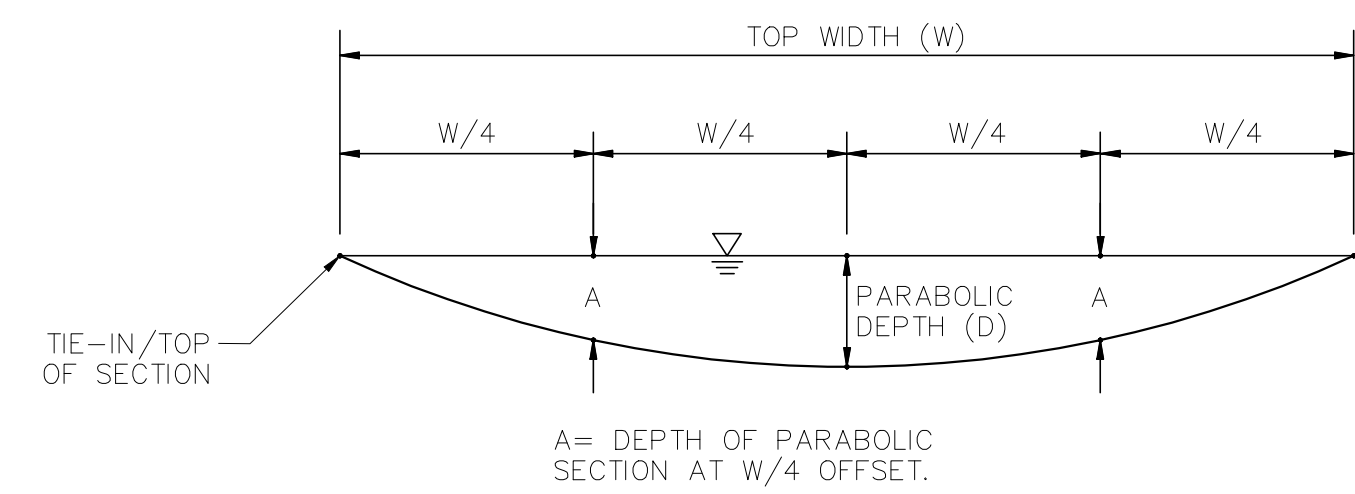

PARABOLIC SECTION DIMENSIONS
NOT TO SCALE

SAND / WOODCHIP MIXTURE	
80%	SAND (0.02" TO 0.04")
20%	WOODCHIPS

COMPOST	
pH	5.0 TO 7.0
MOISTURE CONTENT	30-55%
PARTICLE SIZE	0.5" OR LESS

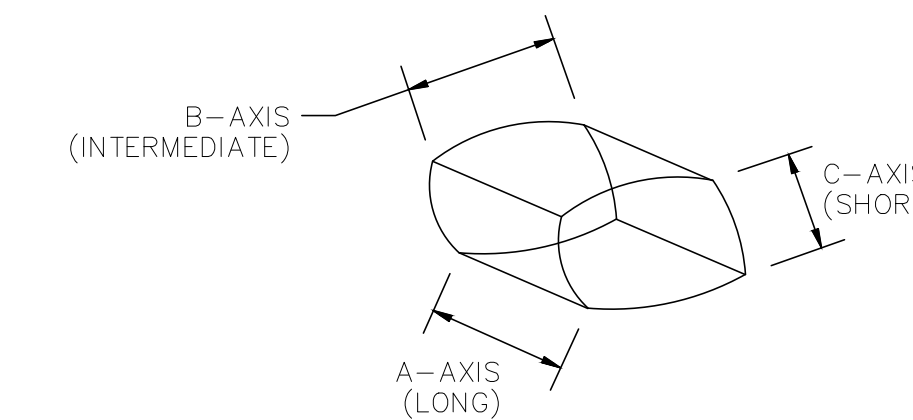

BOULDER AXIS
NOT TO SCALE

- NOTES:
 1. THE MEDIAN A-AXIS DIMENSIONS, ACROSS THE FULL STRUCTURE SHALL EQUAL A MINIMUM OF 30".
 2. BOULDERS SHALL HAVE MINIMUM UNIT WEIGHT OF 165 LBS/CF.

BOULDER DIMENSION TABLE (IN)			
	A-AXIS	A-AXIS	A-AXIS
WEIR AND CASCADE (SURFACE BOULDERS)	24-36"	24-36"	12-24"
FOOTER BOULDERS (SUBSURFACE)	24-36"	24-36"	24-36"

COBBLE GRADATION TABLE			
D50 MEDIAN STONE SIZE (INCHES)	% OF MATERIAL SMALLER THAN TYPICAL STONE	TYPICAL STONE EQUIVALENT DIAMETER (INCHES)	TYPICAL STONE WEIGHT (POUNDS)
6	70-100	12	85
	50-70	9	35
	35-50	6	10
	2-10	2	0.4
9	70-100	15	160
	50-70	12	85
	35-50	9	35
	2-10	3	1.3
12	70-100	21	440
	50-70	18	275
	35-50	12	85
	2-10	4	3
18	100	30	1280
	50-70	24	650
	35-50	18	275
	2-10	6	10
24	100	42	3500
	50-70	33	1700
	35-50	24	650
	2-10	9	35

NOTE:
STREAM COBBLE SHALL BE SILICA COBBLE RANGING FROM ROUNDED TO SUB-ANGULAR SHAPE.

30% SCHEMATIC DESIGN

DE-01

Apr 11, 2022 - 5:02pm User: kathy.larkin M:\2018\180467_18Drainage\04-06_Detail_Harness.dwg

KCI TECHNOLOGIES INC.
 ENGINEERS AND PLANNERS
 936 RIDGEBROOK ROAD
 SPARKS, MARYLAND
 21152
 (410) 316-7800

"PROFESSIONAL CERTIFICATION. I HEREBY CERTIFY THAT THESE DOCUMENTS WERE PREPARED OR APPROVED BY ME, AND THAT I AM A DULY LICENSED PROFESSIONAL ENGINEER UNDER THE LAWS OF THE STATE OF MARYLAND, LICENSE NO. 31201, EXPIRATION DATE: 2/1/2023."

SIGNATURE _____ DATE _____

ANNE ARUNDEL COUNTY			
DEPARTMENT OF PUBLIC WORKS			
REVISIONS	APPROVED	DATE	APPROVED
NO. DATE BY			
	CHIEF ENGINEER		PROJECT MANAGER
	APPROVED	DATE	APPROVED
	WPRP ADMINISTRATOR		CHIEF RIGHT-OF-WAY
SCALE: AS SHOWN		DRAWN BY: KL	
CHECKED BY: JT		RSC DETAILS	
SHEET NO. 4 OF 6		HARNESS CREEK GULLY REPAIR	
PROJECT NO.: P584600		APRIL 2022	
CONTRACT NO.: P584605		2ND ELECTION DISTRICT, TAX MAP 56, PARCEL 88, GRID 17, ZONING OS, ZIP CODE 21403	

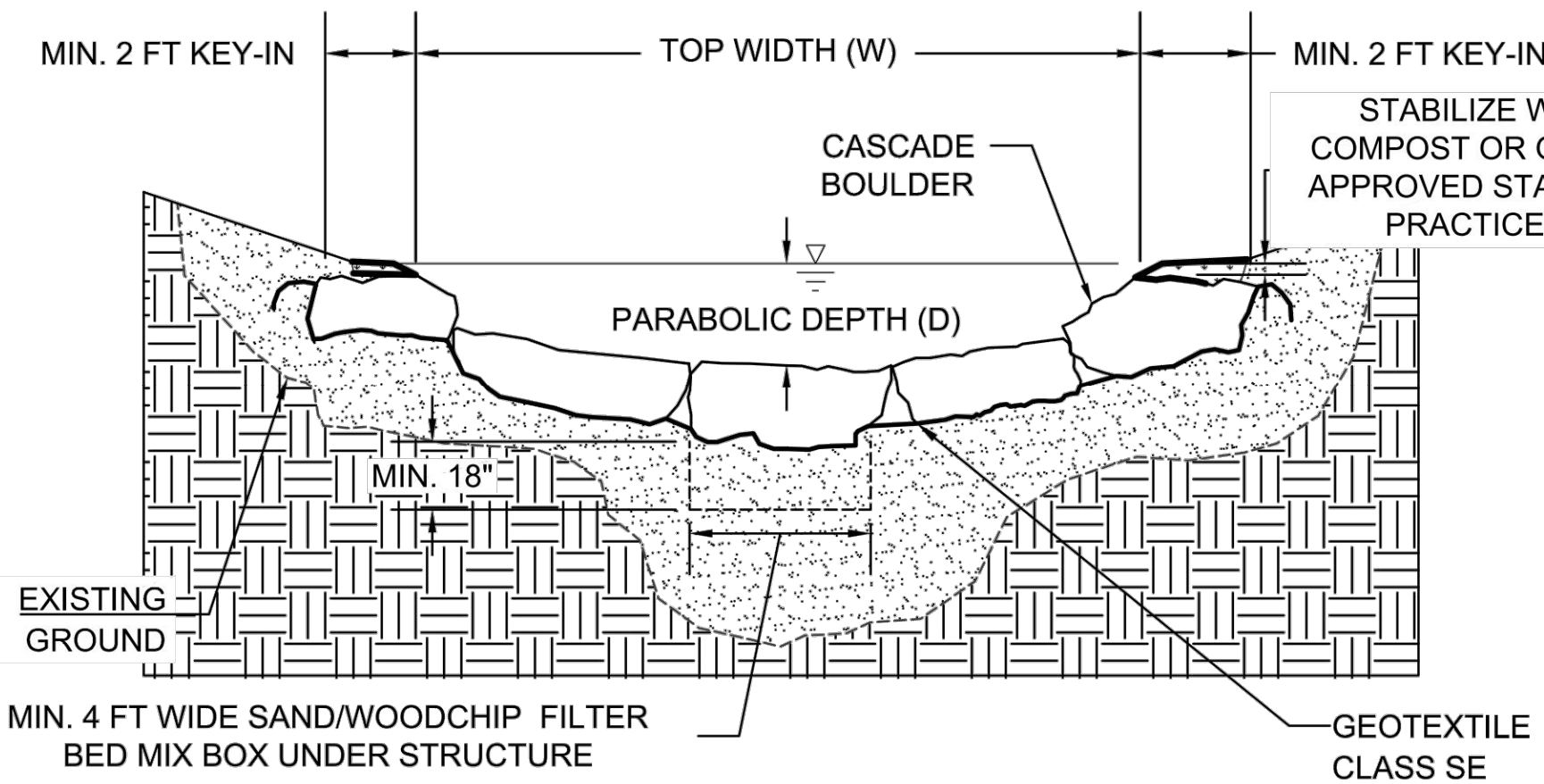

CASCADe TYPICAL SECTION B-B
NOT TO SCALE

- NOTES:
- 1) ALL BOULDERS SHALL BE CHINKED WITH SMALL COBBLE OR BOULDER FRAGMENTS TO FILL VOIDS AND PROMOTE SURFACE FLOW OVER THE BOULDERS.
 - 2) BOULDERS AS DISPLAYED REFLECT VARIABILITY IN STONE DIMENSION WITHIN THE MINIMUM SIZE REQUIREMENTS. THE CONTRACTOR IS RESPONSIBLE FOR SELECTING APPROPRIATE MATERIAL TO MEET THE LENGTH, WIDTH, DEPTH, AND SLOPE REQUIREMENTS AS OUTLINED ON THIS SHEET. THE NUMBER OF BOULDERS AND THEIR CONFIGURATION MAY VARY FROM THIS PLAN.

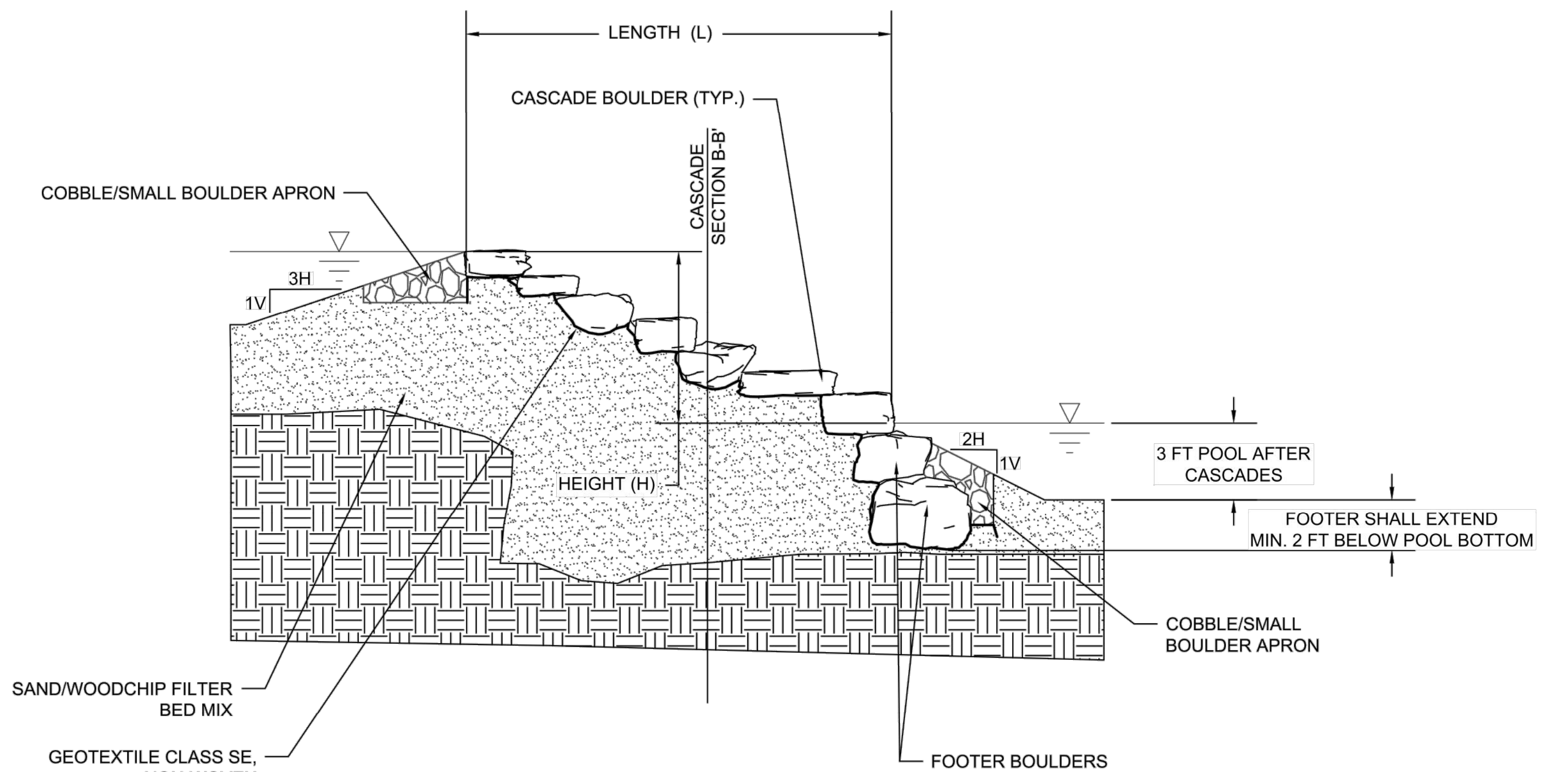

CASCADe PROFILE TYPICAL
NOT TO SCALE

RIFFLE GRADE CONTROL & CASCADE DIMENSION TABLE								
TYPE	L (FT.)	W (FT.)	H (FT.)	B (FT.)	D (FT.)	A (FT.)	D50 (IN.)	T (IN.)
RIFFLE	8	16	1	VARIES	1	0.75	9	24
CASCADE	8	16	2	-	1	-	-	-

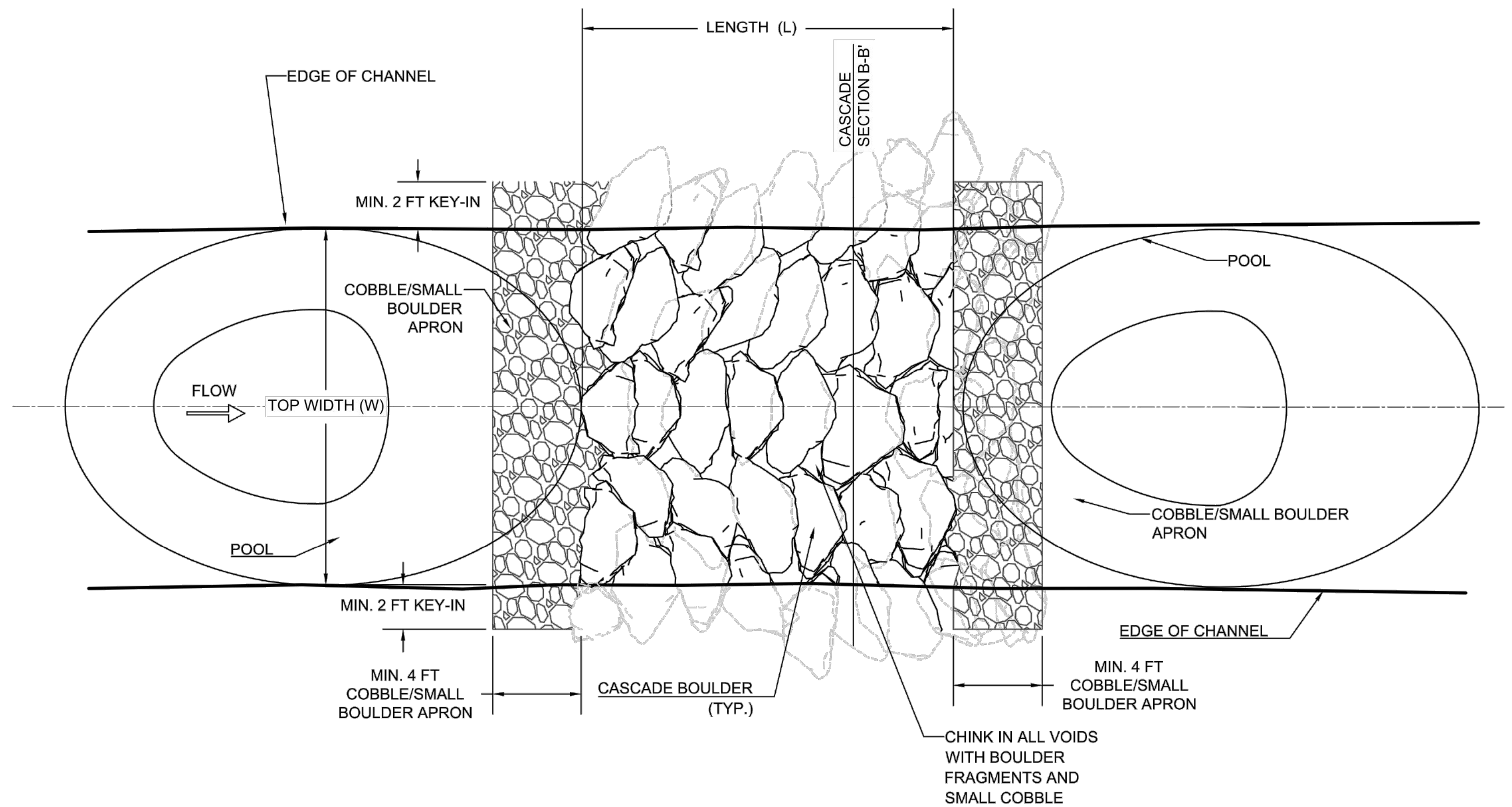

CASCADe PLAN TYPICAL
NOT TO SCALE

30% SCHEMATIC DESIGN DE-02

Apr 11, 2022 - 4:59pm User: kathy.larkin M:\2018\171046671\171046671.dwg

KCI
TECHNOLOGIES INC.
ENGINEERS AND PLANNERS
936 RIDGEBROOK ROAD
SPARKS, MARYLAND
21152
(410) 316-7800

"PROFESSIONAL CERTIFICATION. I HEREBY CERTIFY THAT THESE DOCUMENTS WERE PREPARED OR APPROVED BY ME, AND THAT I AM A DULY LICENSED PROFESSIONAL ENGINEER UNDER THE LAWS OF THE STATE OF MARYLAND, LICENSE NO. 31201, EXPIRATION DATE: 2/1/2023."

SIGNATURE _____ DATE _____

ANNE ARUNDEL COUNTY			
DEPARTMENT OF PUBLIC WORKS			
REVISIONS		APPROVED	DATE
NO.	DATE	BY	
		APPROVED	DATE
		WPRP ADMINISTRATOR	
		APPROVED	DATE
		CHIEF ENGINEER	
		APPROVED	DATE
		CHIEF RIGHT-OF-WAY	
		APPROVED	DATE
		PROJECT MANAGER	
		APPROVED	DATE
		CHIEF RIGHT-OF-WAY	
		SCALE: AS SHOWN	
		DRAWN BY: KL	
		CHECKED BY: JT	
		SHEET NO. 5 OF 6	
		PROJECT NO.: P584600	
		CONTRACT NO.: P584605	
RSC DETAILS			
HARNESS CREEK GULLY REPAIR			
APRIL 2022			
2ND ELECTION DISTRICT, TAX MAP 56, PARCEL 88, GRID 17, ZONING OS, ZIP CODE 21403			

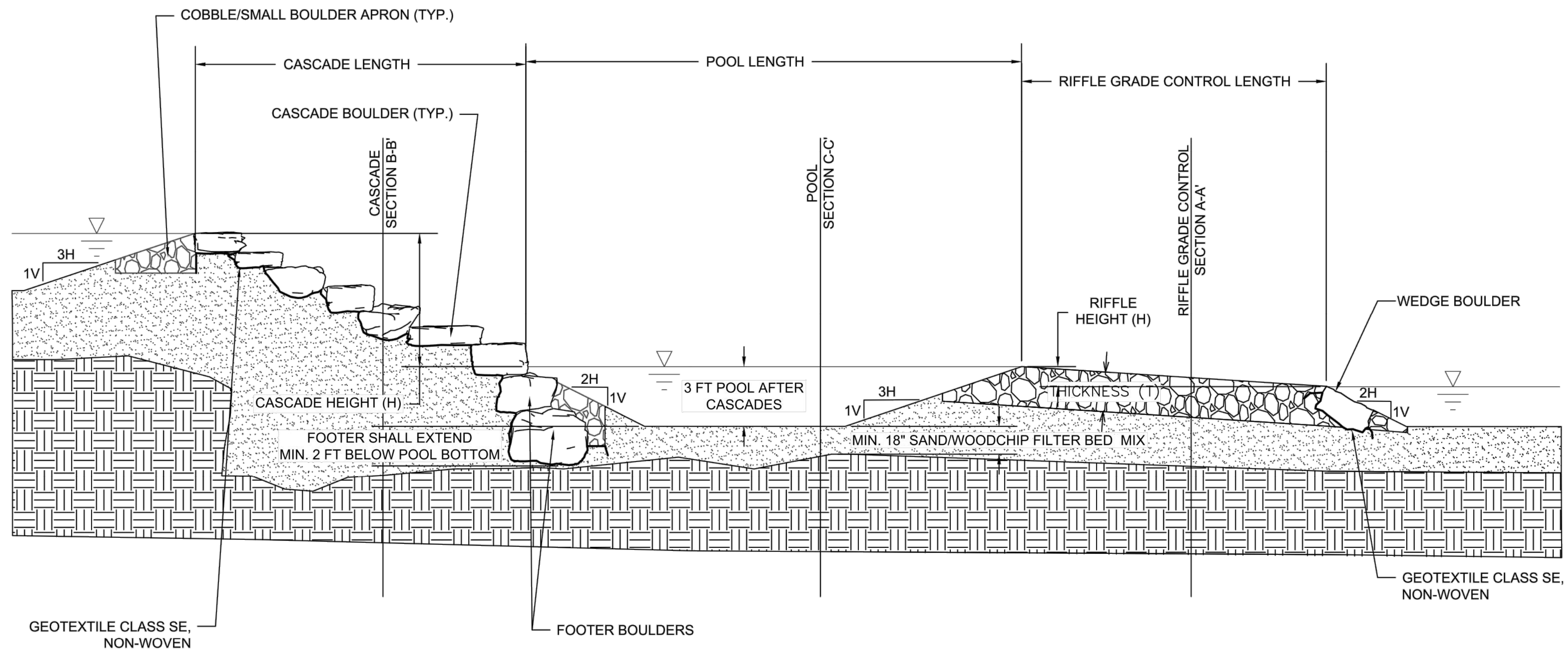

CASCADE AND RIFFLE GRADE CONTROL SEQUENCE
TYPICAL CENTERLINE PROFILE
NOT TO SCALE

Apr 11, 2022 - 5:03pm User: kathy.larkin M:\2018\17104667\16\Drawings\04-06_Detail_HarnessCZ.dwg



KCI
TECHNOLOGIES INC.
ENGINEERS AND PLANNERS
936 RIDGEBROOK ROAD
SPARKS, MARYLAND
21152
(410) 316-7800

"PROFESSIONAL CERTIFICATION. I HEREBY CERTIFY THAT THESE DOCUMENTS WERE PREPARED OR APPROVED BY ME, AND THAT I AM A DULY LICENSED PROFESSIONAL ENGINEER UNDER THE LAWS OF THE STATE OF MARYLAND, LICENSE NO. 31201, EXPIRATION DATE: 2/1/2023."

SIGNATURE _____ DATE _____

APPROVED _____ DATE _____

CHIEF ENGINEER

APPROVED _____ DATE _____

WPRP ADMINISTRATOR

ANNE ARUNDEL COUNTY			
DEPARTMENT OF PUBLIC WORKS			
REVISIONS		APPROVED DATE	APPROVED DATE
NO.	DATE	BY	SCALE: AS SHOWN
			DRAWN BY: KL
			CHECKED BY: JT
			SHEET NO. 6 OF 6
			PROJECT NO.: P584600
			CONTRACT NO.: P584605
		PROJECT MANAGER	RSC DETAILS
		CHIEF RIGHT-OF-WAY	
			HARNESS CREEK GULLY REPAIR APRIL 2022 2ND ELECTION DISTRICT, TAX MAP 56, PARCEL 88, GRID 17, ZONING OS, ZIP CODE 21403