

All those lots or parcels of ground situate, lying and being in the Third Assessment District of Anne Arundel County, State of Maryland, and described as follows:

PARCEL NO. 1

Lots 1, 2, and 3 of Block O, Marley Park Beach, as shown on the Plat of Marley Park Beach, and recorded, on October 19, 1922, among the land records of Anne Arundel County in Plat 13, Plat Book 2, at Page 19.

PARCEL NO. 2

BEGINNING for the same at a point on the Northwestern most side of Highland Road, Marley Park Beach, which marks the Southeasternmost corner of Lot 3, Block O, Marley Park Beach, as shown on the Plat of Marley Park Beach as recorded in the Plat Records of Anne Arundel County, Maryland, in Plat Book 2, Page 19; thence from the point of beginning so fixed and binding on the aforesaid side of Highland Road, South 48 degrees 18 minutes West, 184.49 feet to a point of curve; thence with a curve to the right having a radius of ten (10) feet an arc distance of 27.63 feet to the point of tangent on the Southeasternmost side of Summit Avenue; thence with said side of Summit Avenue, North 19 degrees 35 minutes East, 202.25 feet to a point which marks the Northeasternmost corner of Lot 3, Block O, Marley Park Beach; thence leaving the aforementioned side of Summit Avenue, North 70 degrees 25 minutes West, 5.0 feet; thence with a line parallel to and five (5) feet Northwesterly from the Southeasternmost side of Summit Avenue as shown on the Plat of Marley Park Beach, South 19 degrees 35 minutes West, 202.25 feet to a point of curve; thence with a curve to the left having a radius of fifteen (15) feet an arc distance of 41.44 feet to the point of tangent; thence with a line parallel to and five (5) feet Southeasterly from the Northwesternmost side of Highland Road, as shown on the Plat of Marley Park Beach, North 48 degrees 18 minutes East, 184.49 feet; thence leaving said line North 41 degrees 42 minutes West, 5.0 feet to the point of beginning; as more fully shown on a plat entitled "Proposed 5' Strip to be Deeded to Marley Park Fire Department, and recorded, on October 30, 1957, among the land records of Anne Arundel County, Maryland, in Deed Book 1162, at Page 315.

AND BEING all of those parcels of land conveyed by Articles of Sale and Transfer dated March 24, 1987 from The Marley Volunteer Fire Company, Inc., a Maryland corporation to Anne Arundel County, Maryland, a body corporate and politic of the State of Maryland, and recorded, on August 7, 1987, among the Land Records of Anne Arundel County, Maryland in Deed Book 4425, at page 721.

TOGETHER with the building and improvements thereupon erected, made or being and all and every rights, alleys, ways, privileges, appurtenances and advantages, to the same belonging, or anywise appertaining.

SUBJECT TO any and all easements, agreements, covenants, or restrictions of record.



**Legend**

- OPZ Parcels
- Annapolis City Parcels

1: 2,400

400.0 0 200.00 400.0 Feet

NAD\_1983\_HARN\_StatePlane\_Maryland\_FIPS\_1900\_Feet  
 © Latitude Geographics Group Ltd.

This map is a user generated static output from an Internet mapping site and is for reference only. Data layers that appear on this map may or may not be accurate, current, or otherwise reliable.  
 THIS MAP IS NOT TO BE USED FOR NAVIGATION

**Notes**

**Resolution No. 21-18  
 EXHIBIT B**

NOTE APPROVED AS TO CONCRETE CURBING

LIBER 1162 PAGE 315

*Roy Crostie*

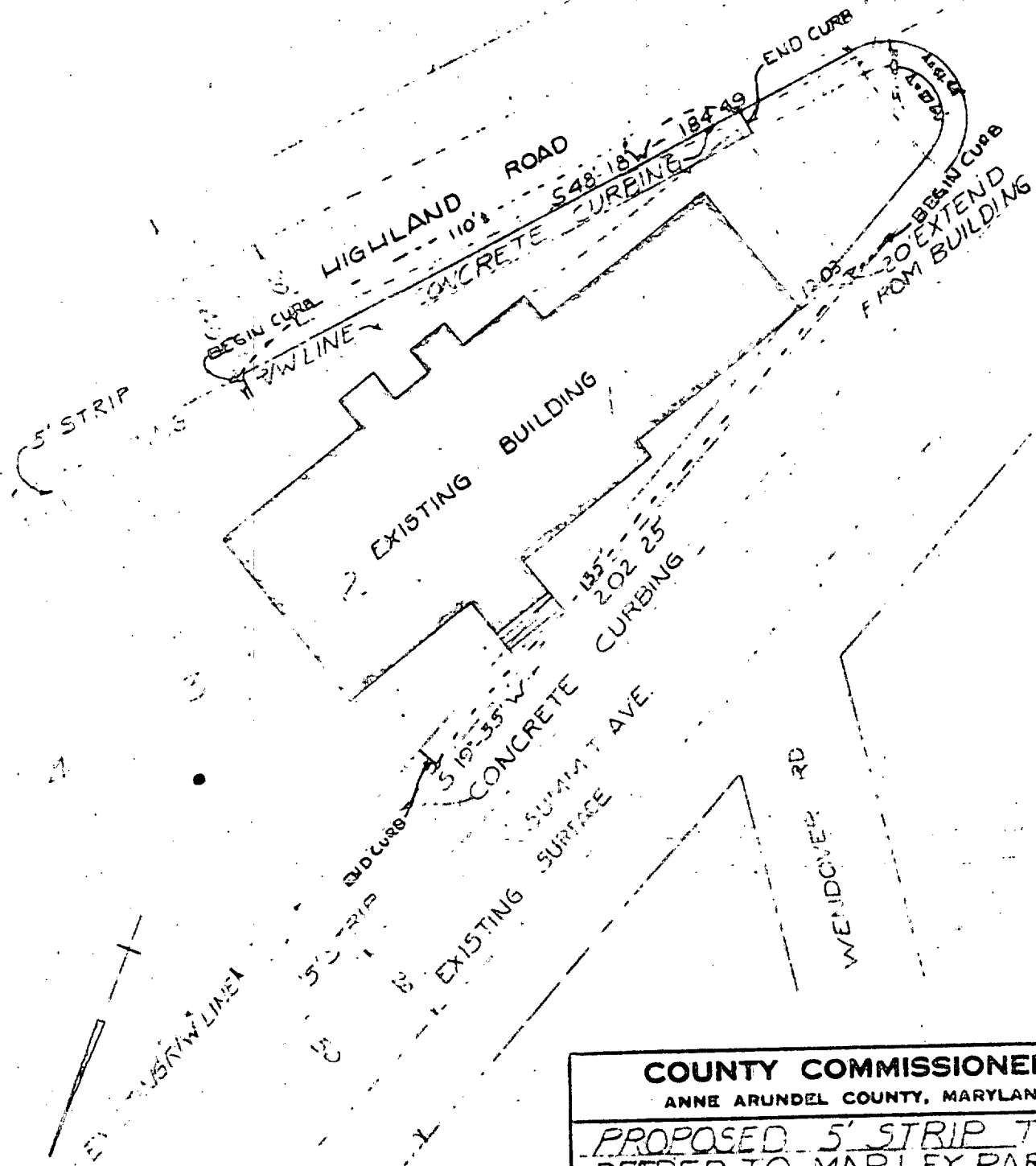

NOTE CONCRETE CURB TO BE INSTALLED ALONG RAW LINE FROM FRONT OF FIRE HALL TO BACK.

<b>COUNTY COMMISSIONERS</b>	
ANNE ARUNDEL COUNTY, MARYLAND	
PROPOSED 5' STRIP TO BE DEEDED TO MARLEY PARK FIRE DEPARTMENT DIST. 3 A A Co. Md.	
SCALE: 1" = 30'	DATE: 6/27/57
APPROVED: <i>T. J. Pantales</i> DIRECTOR OF PUBLIC WORKS	