

Letter of Explanation For
1227 Turkey Point RD. Edgewater, MD. 21037
The Hess Residence

We are seeking a variance to construct an angled pier extension and install 4 poles for a boat lift. We are requesting to construct a 6'w x 12'l pier extension 6 feet off the **east** extended property line and a 10'w x 12'l boat lift and 4 poles, 1 foot of the **west** extended property line. All work a max of 49 feet channel ward of the mean high-water line. This request does not change the landscape of the Turkey Point community as many adjacent properties have one or more boat lifts / slips. Currently 1227 Turkey Point RD. does not have a boat lift or slip.

Please contact me with any information or questions.

Best,

Mike Marsh

mmarsh@magnumlift.com

443-250-3772

Boat Lifts Unlimited

1901 Betson Ct.

Odenton, MD. 21113

Ramsay LAKE

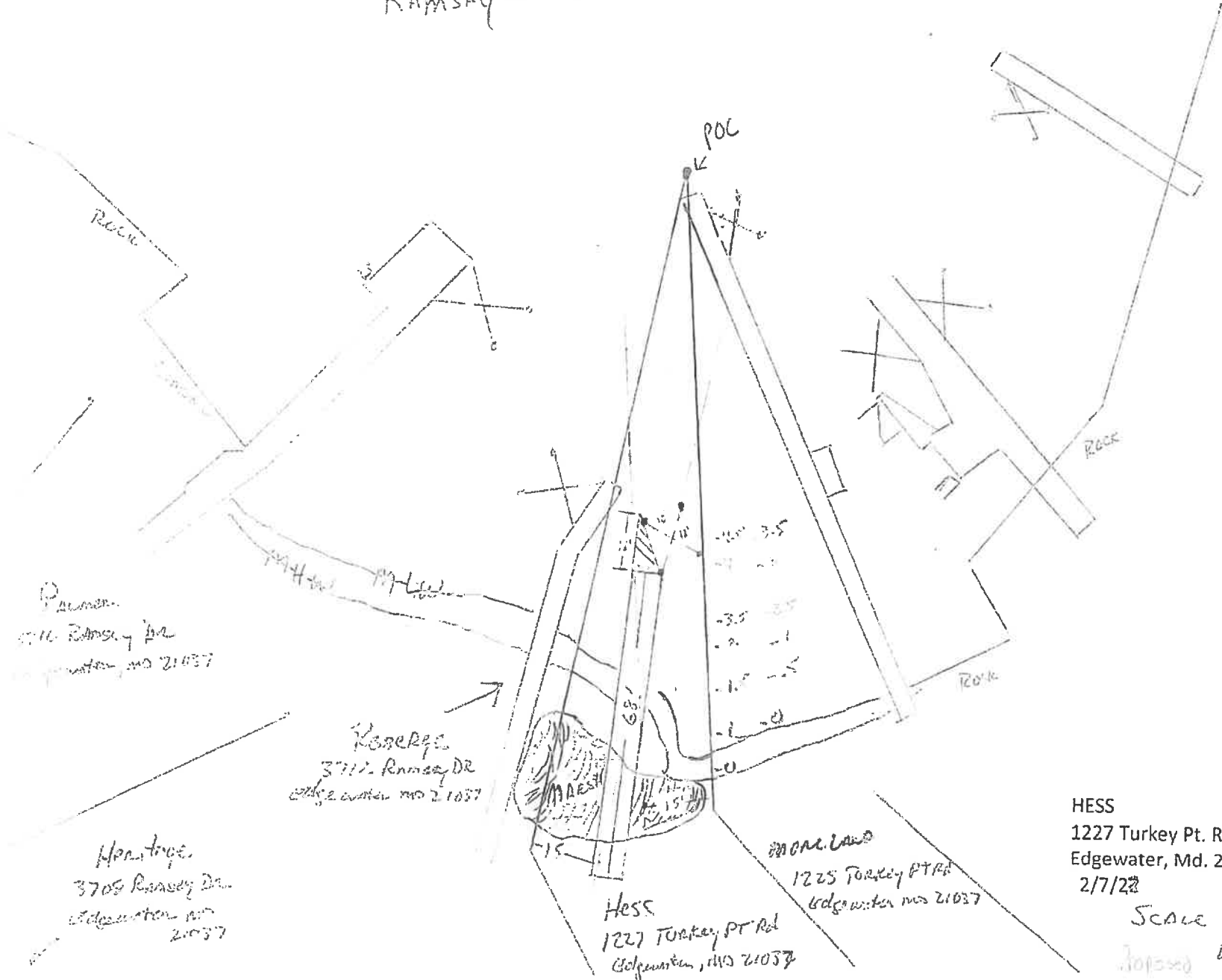

Palmer
 4716 Ramsay Dr
 Edgewater, MD 21037

Konerepc
 3717 Ramsay Dr
 Edgewater, MD 21037

Hon. Troye
 3709 Ramsay Dr.
 Edgewater, MD 21037

Hess
 1227 Turkey Pt Rd
 Edgewater, MD 21037

BRONX LAND
 1225 Turkey Pt Rd
 Edgewater, MD 21037

Hess
 1227 Turkey Pt. Rd
 Edgewater, Md. 21037
 2/7/22

Revised
 7/17/23

SCALE 1:30
 J. J. J. Layout

RAMSEY LAKE

POC

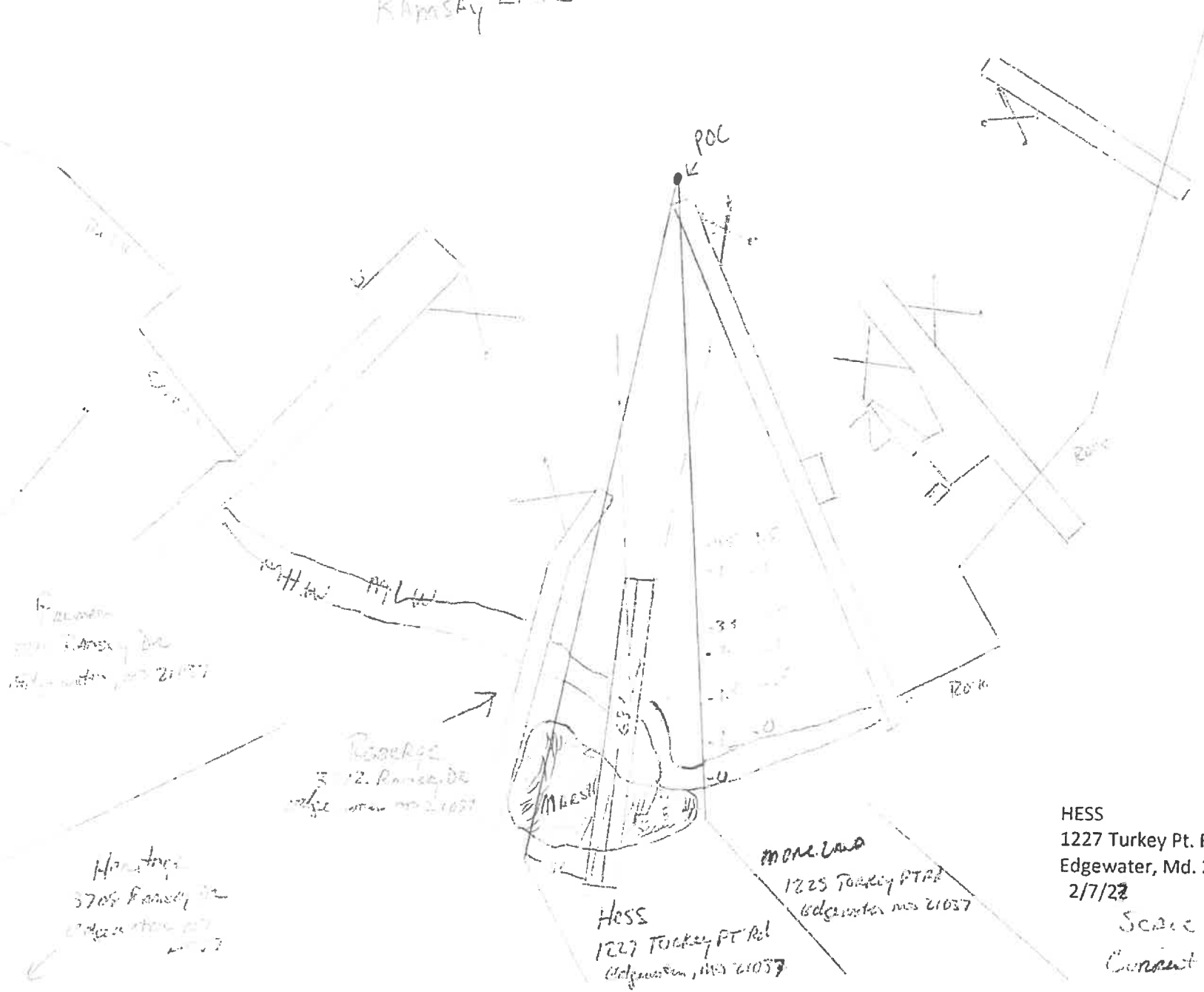

RAMSEY
3705 Ramsey Dr
Edgewater, MD 21037

RAMSEY
3702 Ramsey Dr
Edgewater, MD 21037

HANCOCK
3709 Ramsey Dr
Edgewater, MD 21037

HESS
1227 Turkey Pt Rd
Edgewater, MD 21037

more land
1225 Turkey Pt Rd
Edgewater, MD 21037

Revised
7/17/33

HESS
1227 Turkey Pt. Rd
Edgewater, Md. 21037
2/7/22

Scale 1:30
Current Layout