

HIDDEN POINT ROAD WETLAND

VEGETATED FILTER STRIP
 - 20' WIDE GRASS FILTER STRIP AT 5% GRADE REMOVES 95% OF SEDIMENTS
 - MOAT UPSTREAM OF FILTER STRIP ACTS AS LEVEL SPREADER TO MAXIMIZE EFFICIENCY

EXISTING SOD FIELD CONVERTED TO WETLAND
 - CREATED WETLAND COLLECTS STORES, AND INFILTRATES AGRICULTURAL RUNOFF
 - ADDITIONALLY, SOD FIELDS ARE TAKEN OUT OF PROJECT, REDUCING LOADING RATES

SAND SEEPAGE WETLAND CREATION
 - CREATE SHALLOW POOLS TO SLOW DOWN AND INFILTRATE STORMWATER RUNOFF
 - FILTERS STORMWATER TO REMOVE FINE SEDIMENTS BY PLANTS AND CONVERSION TO GROUNDWATER
 - WETLAND HABITAT SUPPORTS RARE AND THREATENED FLORA AND FAUNA, AND GAME SPECIES

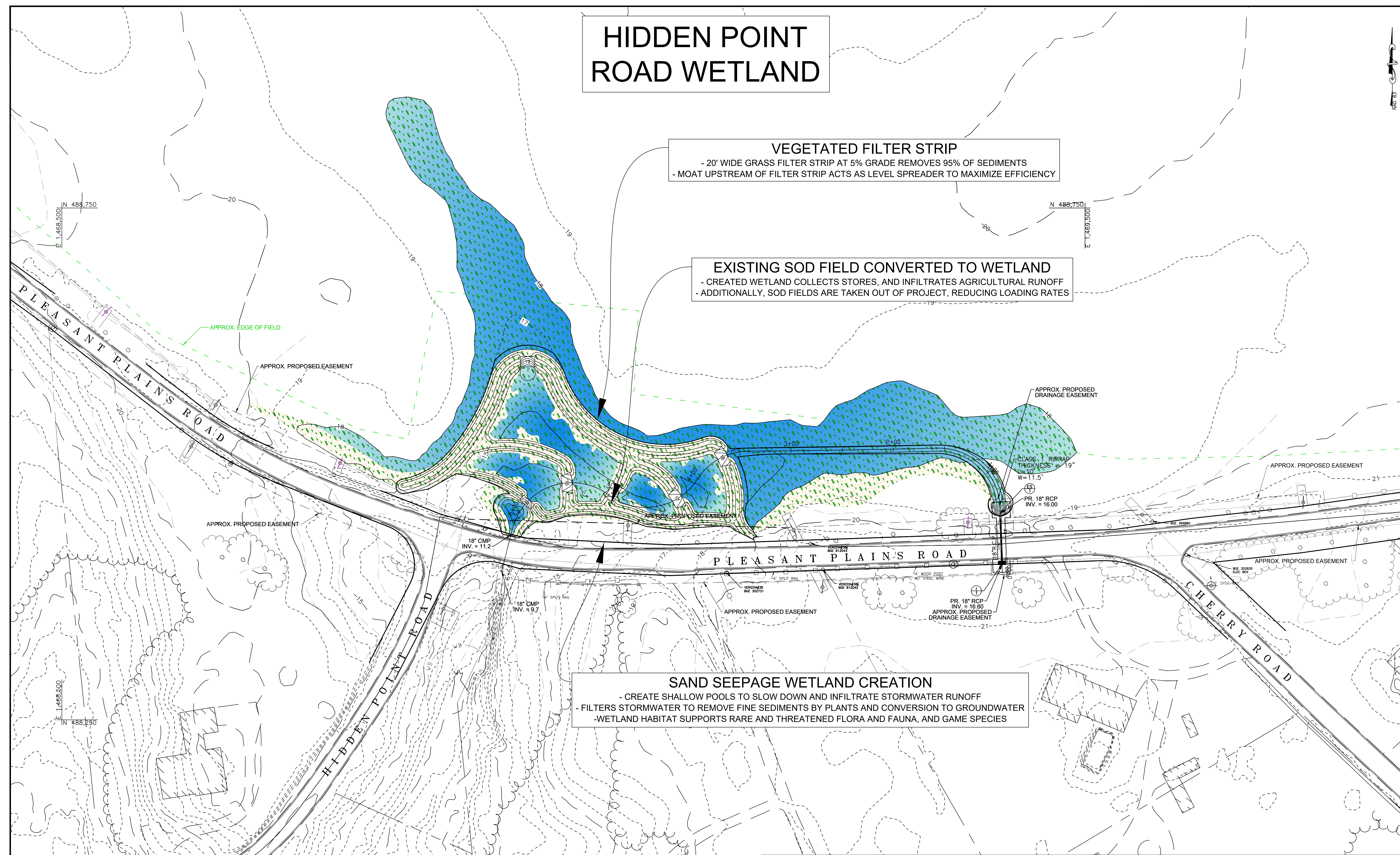

UNDERWOOD & ASSOCIATES
 LANDSCAPE ARCHITECTURE • ECOLOGICAL RESTORATION
 DESIGN/BUILD Co.
 SCALE: 1"=40'
 1753 EBLING TRAIL • ANNAPOLIS, MD 21401
 Tel. 410-849-3233 Fax. 410-849-2136

DAVID J. WALLACE, P.E.
 PROFESSIONAL CERTIFICATION
 I, DAVID J. WALLACE, CERTIFY THAT THESE DOCUMENTS WERE PREPARED BY OR APPROVED BY ME, AND THAT I AM A DULY LICENSED PROFESSIONAL ENGINEER UNDER THE LAWS OF THE STATE OF MARYLAND, LICENSE NO. 11466 EXPIRATION DATE: MAY 28, 2025.
 DAVID J. WALLACE, P.E.
 701 CHESAPEAKE AVENUE
 ANNAPOLIS, MARYLAND 21403
 BUSINESS PH. 410.544.1225



AUGUST, 2023

Scale	AS SHOWN	CONCEPTUAL PLAN CENTRAL SOD FARM RETROFIT PROJECT PLEASANT PLAIN ROAD ANNAPOLIS, MARYLAND 21409 MAP 5295, GRID H-8, H-9, J-8 & J-9, PARCEL 0400 FORMERLY MAP 0046, GRID 0011, PARCEL 0176 FORMERLY MAP 0046, GRID 0005, PARCEL 0400 3TH ELECTION DISTRICT, ANNE ARUNDEL COUNTY
Drawn By	J.H./J.K./B.L./E.C.	
Approved By	K.B.	
Sheet No.	6 Of 9	
Project No.	20-082	
Proposal No.	...	Signature _____ Date _____

The techniques used in this design are covered by US Patents # 11047124 & # 11047125, owned by Underwood & Associates, Inc.
 Cadd File: S:\005-Projects\Central Sod Farm Restoration (Dulley Dixon)_Hollywoood\CADD\Drawings\CONCEPT PLAN.dwg (OTTEB: Oct 04, 2023 - 6:14pm)