

Letter of Explanation

1366 McDonald Rd. Shady Side, MD. 20764

George Ceely

Project Description

We are seeking approval to install a 13'w x 15'l boat lift with associated poles (2) and 2 mooring poles with less setbacks than required. The boat lift poles are 6' into the western setback or 9' off of the western extended property line and the mooring poles are 8' into the western setback or 7' off of the western extended property line. All work is a max of 85' channel ward of the mean high-water line.

Hardship

Mr. Ceely has a waterfront footage of 50'. The lot is undersized. Due to the undersized lot a variance approval is required for Mr. Ceely to have a boat lift/slip to achieve proper water depth and not affect navigation of adjacent properties. The addition of a boat lift and slip to Mr. Ceely's pier does not change the character of the community as numerous adjacent property owners benefit from multiple boat lifts or slips. Please contact the number or email below with any questions or information.

Best,

Tim Glaser – 240-695-4930

tim@magnumlift.com

Boat Lifts Unlimited

1901 Betson Ct. Odenton, MD. 21113

George Ceely
1366 McDonald Road
Shady Side, MD 20764
2/13/2024

West
River

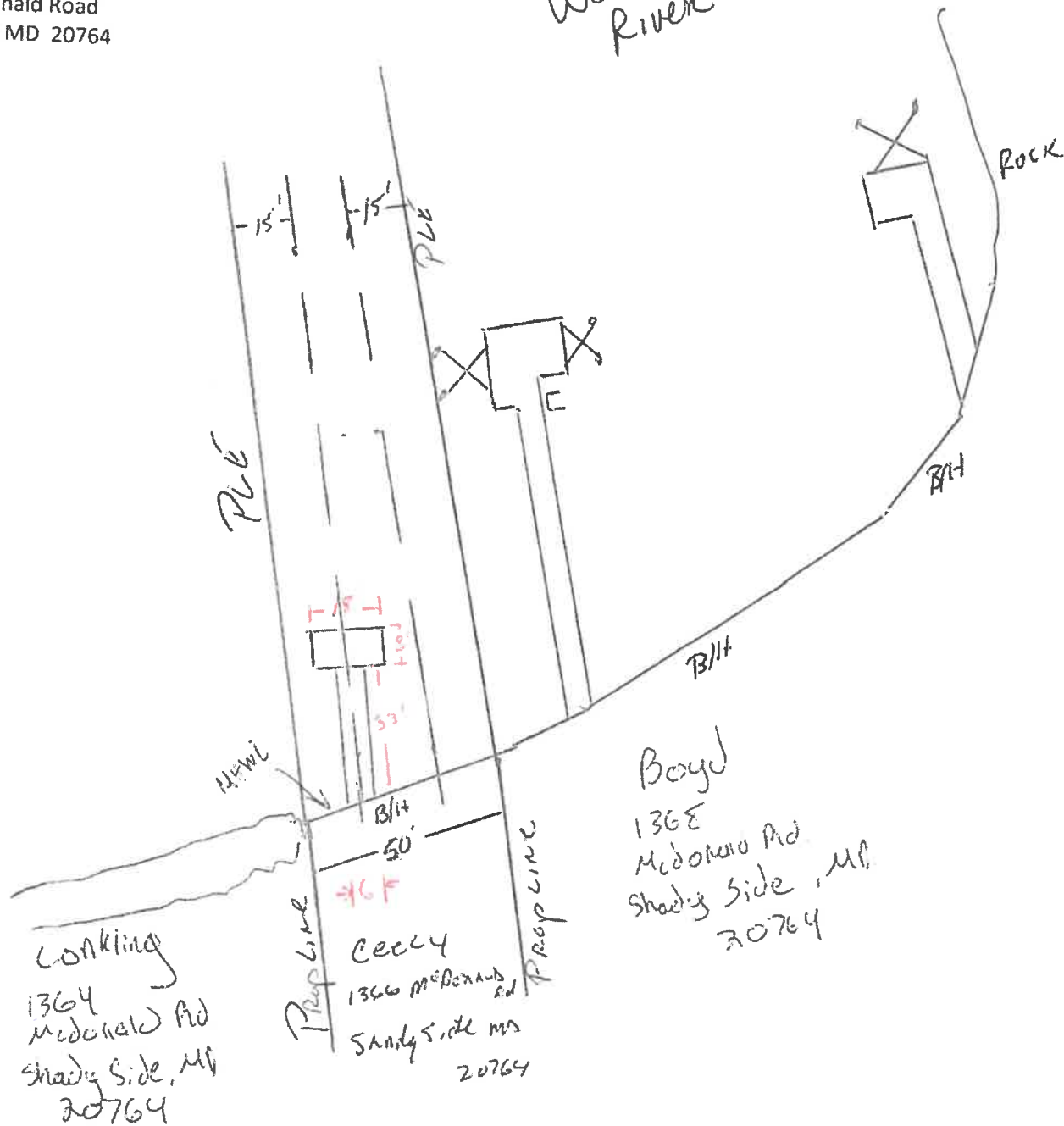

Current Layout
Scale 1:40

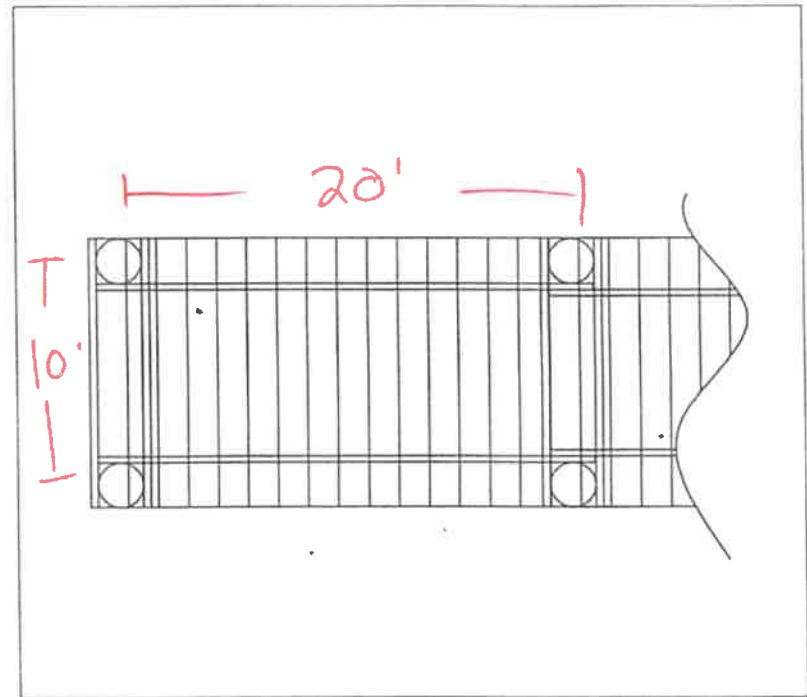
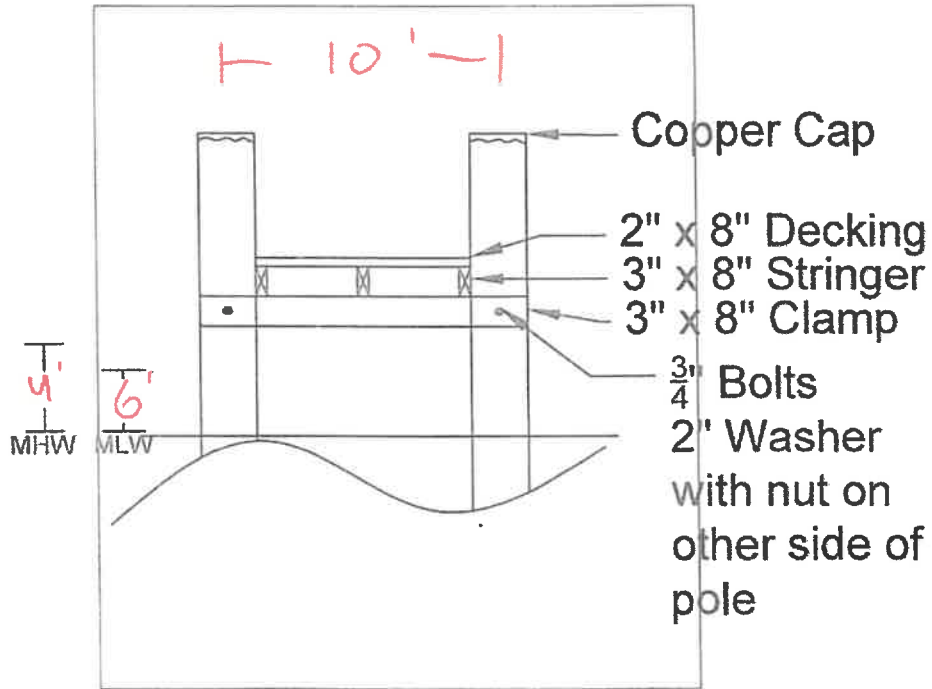

10'w x 20'l platform

George Ceely
 1366 McDonald Road
 Shady Side, MD 20764
 2/13/2024

Boat Lifts Unlimited
 Platform Cross Section
 Not to Scale

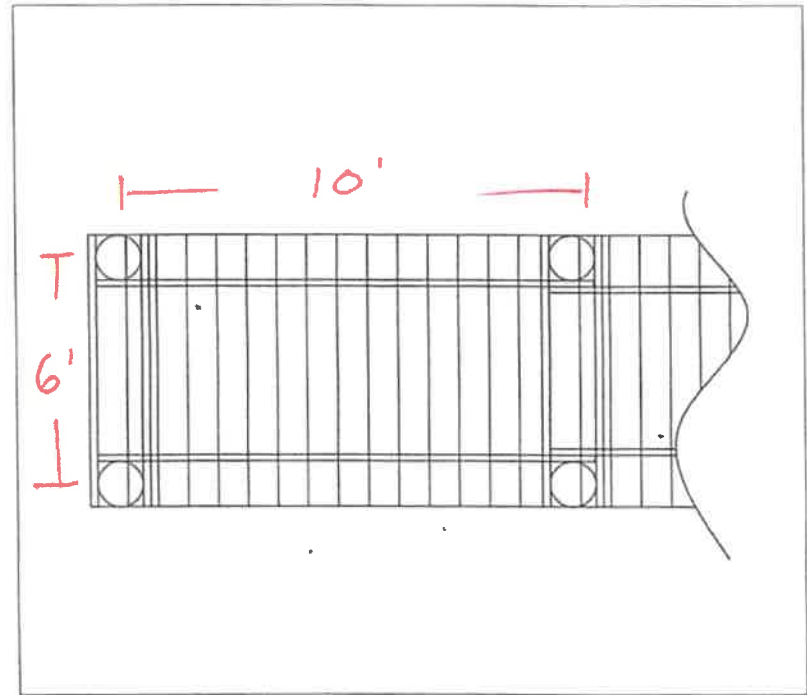
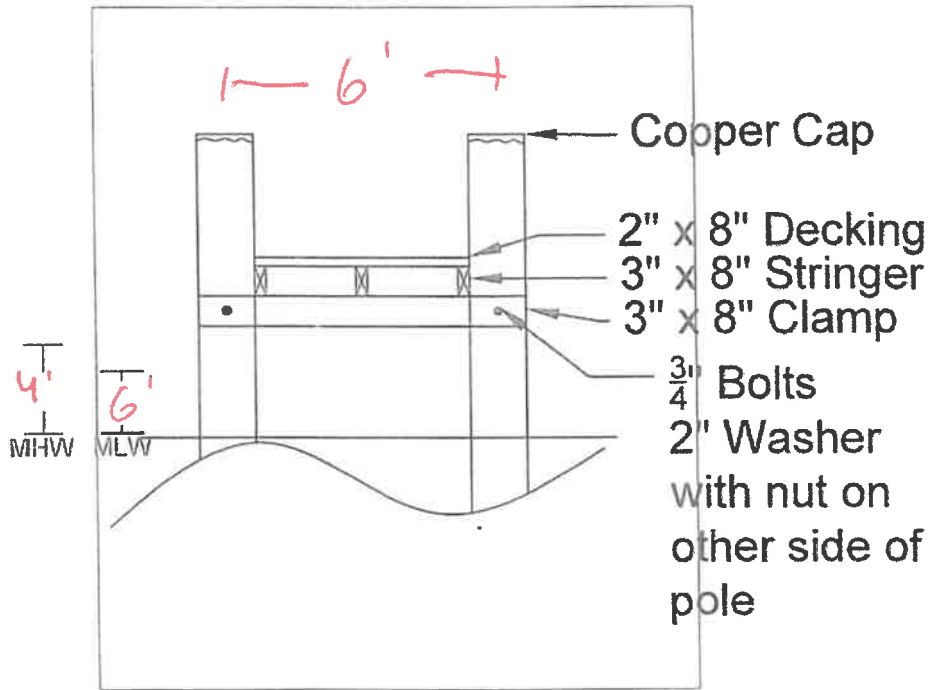

6'w x 70'L Pier

George Ceely
 1366 McDonald Road
 Shady Side, MD 20764
 2/13/2024

Boat Lifts Unlimited
 Platform Cross Section
 Not to Scale

GENERAL NOTES:

1. FOR LIST OF MATERIALS RELATED TO PART NUMBERS, SEE PARTS LIST.

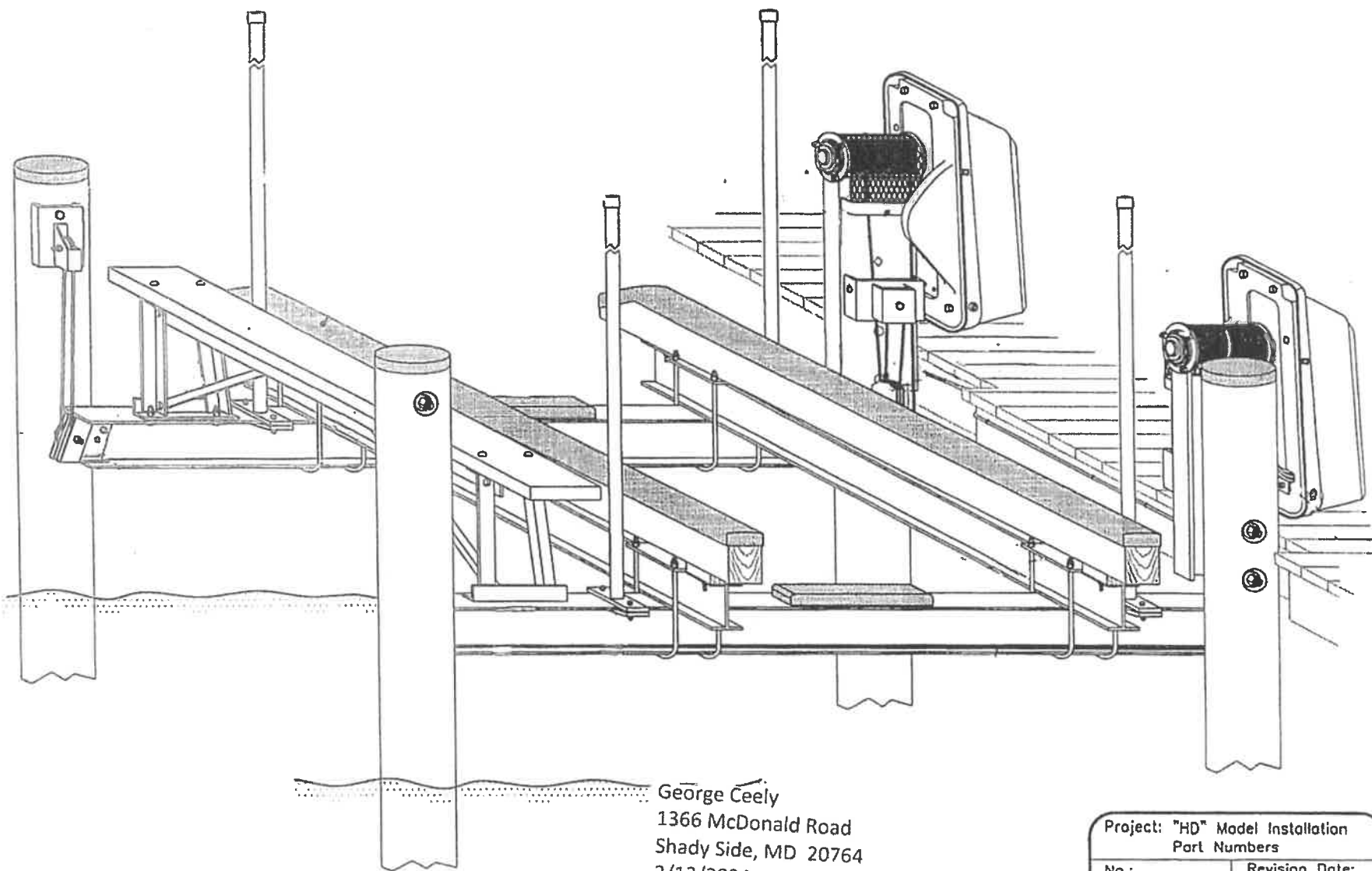

George Ceely
1366 McDonald Road
Shady Side, MD 20764
2/13/2024

Project: "HD" Model Installation Part Numbers		
No.: 002	Revision Date:	
Scale: None	Date: 02-22-01	Sheet: 1 of 1



George Ceely
 1366 McDonald Road
 Shady Side, MD 20764
 2/13/2024

George Ceely
1366 McDonald Road
Shady Side, MD 20764
2/13/2024

