

Letter of Explanation

1030 Wiers Rd. Edgewater, MD. 21037

Kristie Conway

**Project Description**

We are seeking approval for the use of a pier and boat slips/ lifts on a lot that does not have a dwelling. We are also seeking approval to replace and relocate 2 mooring poles to accommodate a 12'w x 10'l boat lift, with less setbacks than required. The poles are 14 feet into the western setback or 1 foot off the western extended property line. All work a max of 100' channel ward of the mean high-water line.

**Hardship**

The property in question has been passed down through generations of Ms. Conway's family. The property's use has always been to access the pier. Ms. Conway currently resides at 1017 Wiers Rd. Edgewater, MD. 21037, which is a non-waterfront lot. She is a member of the community and wishes to use the lot for pier access, as used for generations. The property of 1030 Wiers is only 27 feet wide meaning it could not accommodate a SFD on site. This width of 27 feet is also important as we discuss the proposed work past the mean high-water line. With the footage classifying this lot as undersized there is no design for a boat lift that would not require a variance as the setbacks overlap by 3 feet. The mooring poles we are seeking to replace and relocate are currently 14 feet into the setback and will not be moving further into the setback. The relocation of the poles is necessary to accommodate for the boat lift. Please contact the number or email below with any questions or information.

Best,

Tim Glaser

240-695-4930

[tim@magnumlift.com](mailto:tim@magnumlift.com)

Boat Lifts Unlimited

1901 Betson Ct.

Odenton, MD. 21113

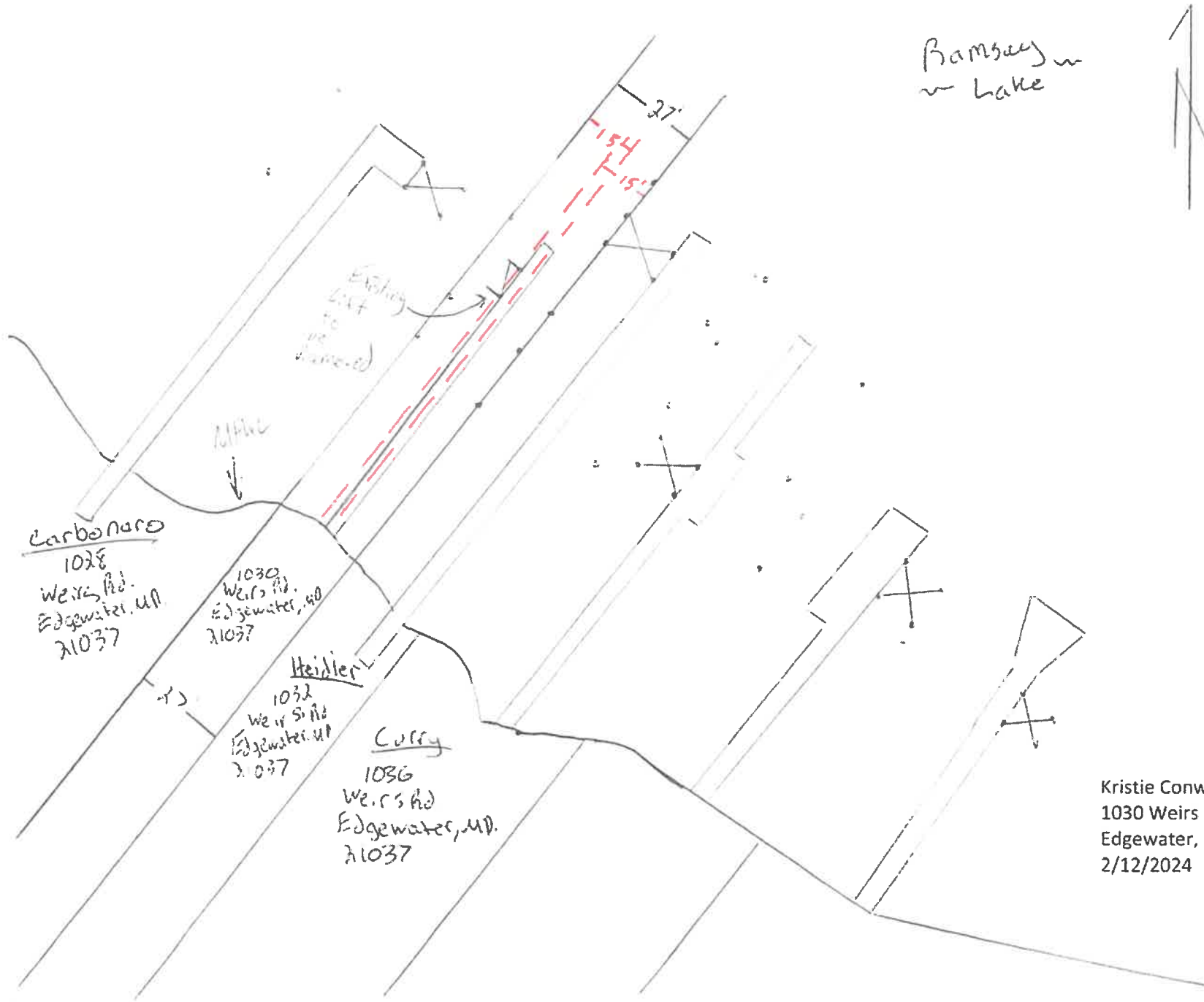

Ramsay  
Lake



Carbonaro  
1028  
Weirs Rd.  
Edgewater, MD  
21037

1030  
Weirs Rd.  
Edgewater, MD  
21037

Heidler  
1032  
Weirs Rd.  
Edgewater, MD  
21037

Curry  
1036  
Weirs Rd.  
Edgewater, MD  
21037

Existing  
Layout  
1/2" = 10' Scale

Kristie Conway  
1030 Weirs Road  
Edgewater, MD 21037  
2/12/2024



Bamsay  
~ Lake



Proposed  
Layout  
1:40 Scale

Kristie Conway  
1030 Weirs Road  
Edgewater, MD 21037  
2/12/2024

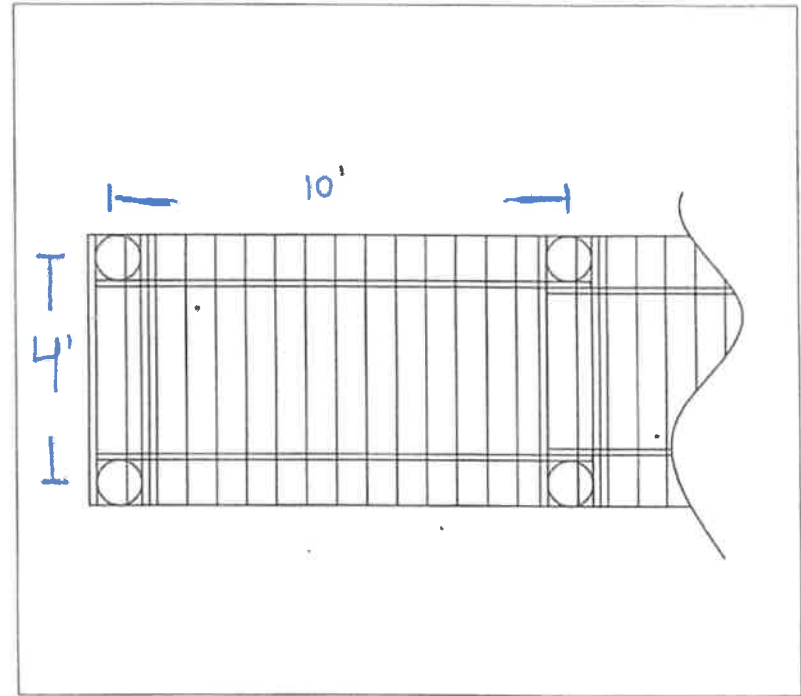
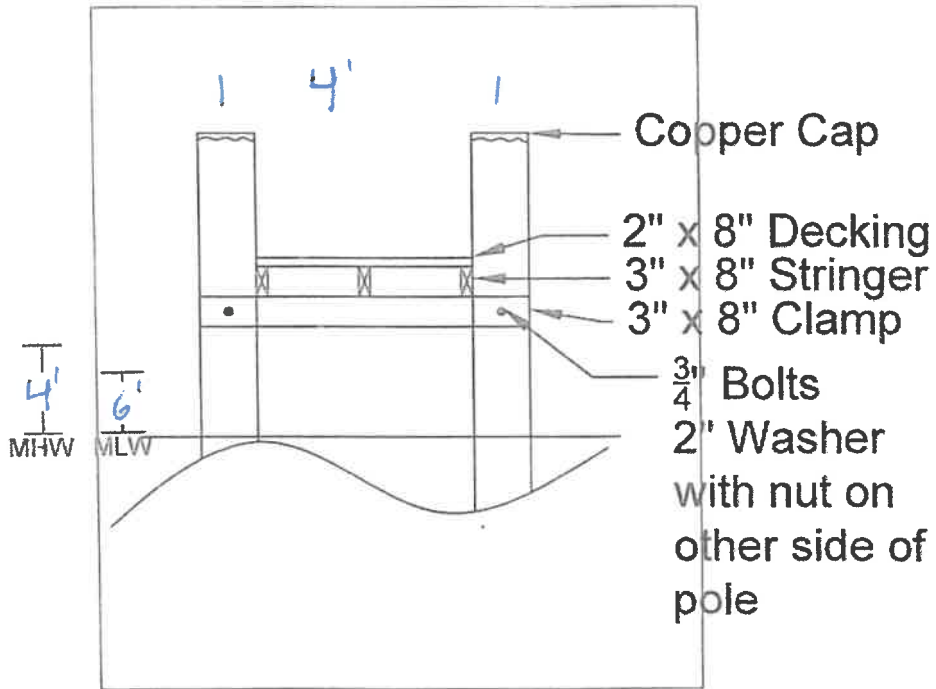

RIK 4'w x 105'L Pier

Kristie Conway  
 1030 Weirs Road  
 Edgewater, MD 21037  
 2/12/2024

Boat Lifts Unlimited  
 Platform Cross Section  
 Not to Scale

**GENERAL NOTES:**

1. FOR LIST OF MATERIALS RELATED TO PART NUMBERS, SEE PARTS LIST.

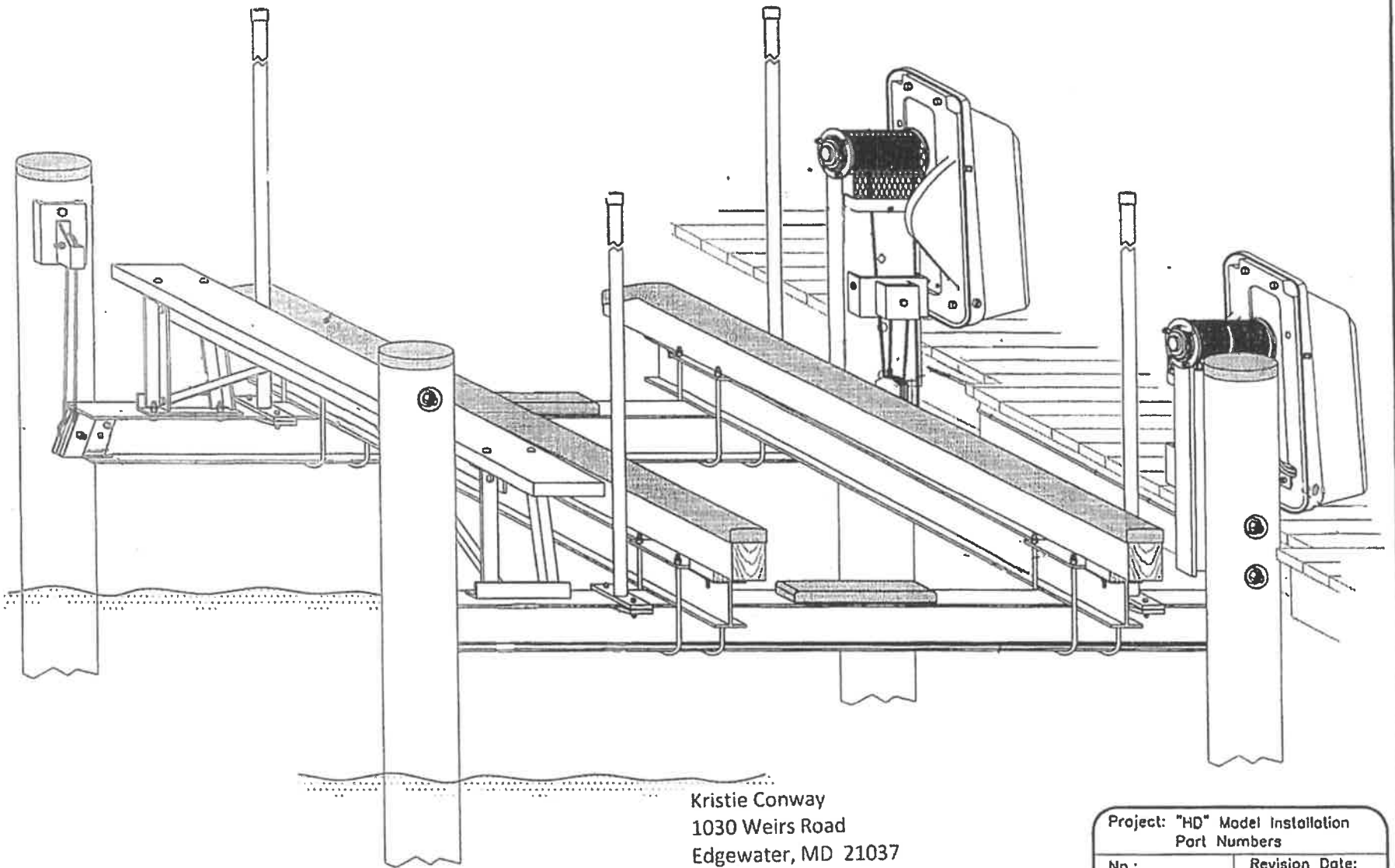

Kristie Conway  
1030 Weirs Road  
Edgewater, MD 21037  
2/12/2024

Project: "HD" Model Installation Part Numbers		
No.: 002	Revision Date:	
Scale: None	Date: 02-22-01	Sheet: 1 of 1





Kristie Conway  
 1030 Weirs Road  
 Edgewater, MD 21037  
 2/12/2024



Kristie Conway  
1030 Weirs Road  
Edgewater, MD 21037  
2/12/2024

